



Starcraftsmanship

'74

Guarantees the
good times

STARCRAFT

Campers

How Starcraftsmanship guarantees the good times.



You and your family buy a camper for one reason . . . to have a good time. The better the camper, the better time you have. That's why we build each Starcraft camper with Starcraftsmanship.

Starcraftsmanship is a philosophy shared by everyone at Starcraft and it becomes a reality in a careful, meticulous design and manufacturing process. We begin by talking to people, like yourself, who tell us how they use the product, what they want and need.

This invaluable input goes to Starcraft engineers in our research and design center who combine their ingenuity and your expressed needs into exciting and down-to-earth designs. This ingenuity in design is why Starcraft



consistently introduces major industry innovations like the first crank-up lifter that lets you set up your Starcraft in five minutes or less.

Next is a step we call human engineering. We take a good look, to make sure we've

correctly interpreted your needs. And we work to refine each new design to give you the greatest comfort and convenience and beauty in the space available.

After that, dedicated craftsmen complete each step of construction using the best materials and component parts. Then, in a series of inspections they check and re-check to make certain you get every bit of value you pay for.

But Starcraftsmanship doesn't stop at the end of the assembly line. There is a nationwide network of dealers who'll help you select the one camper that's right for your family. And help you after the sale if you need service.

So you see, Starcraftsmanship is really much more than a philosophy or manufacturing process. It's the sum total of

good people in every Starcraft plant and dealership across the country working together with a single purpose . . . to guarantee that you have a good time. It's the reason Starcraft campers are the country's number one selling camping trailers. It's the reason each Starcraft camping trailer carries a long term warranty to protect your investment. It's the reason Starcraft has earned a reputation for excellence with both marine and recreational vehicle owners. And it's the reason that, when you own a Starcraft, you have a good time.

That's Starcraftsmanship.

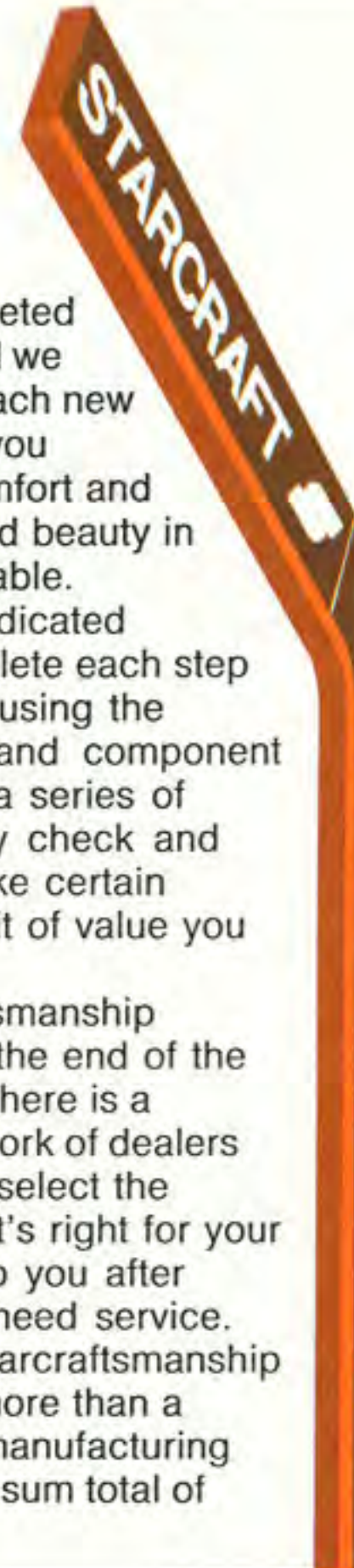

	Starlite 6	Starlite 6	Starmaster 6	Starmaster 8	Stardust 8	Stardust Swinger	Galaxy 6	Galaxy 8	Galaxy Swinger		Starlite 6	Starlite 6	Starmaster 6	Starmaster 8	Stardust 8	Stardust Swinger	Galaxy 6	Galaxy 8	Galaxy Swinger	Individual Option Weight	
Anodized Aluminum Bunk Frames	STD	STD	STD	STD	STD	STD	STD	STD	STD	8' Canopy	OPT	OPT								20 lbs.	
Two Rear Lever Activated Stabilizing Jacks	STD	STD	STD	STD	STD					10' Canopy			OPT	OPT	OPT	OPT				23 lbs.	
Four Lever Activated Stabilizing Jacks						STD	STD	STD	STD	12' Canopy							OPT	OPT	OPT	24 lbs.	
Chrome Hub Caps	STD	STD	STD	STD	STD					8' Add-A-Room*	OPT	OPT†								30 lbs.	
Dexter Wheels						STD	STD	STD	STD	10' Add-A-Room*			OPT	OPT	OPT†	OPT				32 lbs.	
5.30 x 12 6 ply tires	STD	STD	STD	STD						12' Add-A-Room*								OPT	OPT	OPT	36 lbs.
6.50 x 13 6 ply tires					STD	STD	STD	STD	STD	8' Screen Enclosure*	OPT	OPT									13 lbs.
Spare Tire Bracket	STD	STD	STD	STD	STD	STD	STD	STD	STD	10' Screen Enclosure*			OPT	OPT	OPT	OPT					14 lbs.
Four Layer Sandwich Walls	STD	STD	STD	STD	STD	STD	STD	STD	STD	12' Screen Enclosure*								OPT	OPT	OPT	15 lbs.
10" Hydraulic Surge Brakes										Fresh Air Vented Heater			OPT	OPT	OPT	OPT	OPT	OPT	OPT	OPT	35 lbs.
Frame Mounted Bumper		STD	STD	STD	STD	STD	STD	STD	STD	7" Hydraulic Surge Brakes	OPT	OPT	OPT	OPT							25 lbs.
110/12 Volt Converter System (1.5 amp)		STD	STD	STD						10" Hydraulic Surge Brakes					OPT	OPT					25 lbs.
110/12 Volt Converter System (3.0 amp)					STD	STD	STD	STD	STD	Frame Mounted Bumper	OPT										16 lbs.
110 Volt Power Cord		STD	STD	STD	STD	STD	STD	STD	STD	Roof Vent	OPT	OPT									2 lbs.
L.P. Gas Bottle Holder		STD	STD	STD	STD	STD	STD	STD	STD	Door Step	OPT	OPT	OPT	OPT							8 lbs.
Hand Crafted Wood Cabinetry	STD	STD	STD	STD	STD	STD				2.5 cu. ft. Elec. Refrig.			OPT	OPT	OPT	OPT	OPT	OPT	OPT	OPT	41 lbs.
Hand Crafted Decorator Wood Cabinetry							STD	STD	STD	Boat Rack	OPT	OPT	OPT	OPT	OPT	OPT	OPT	OPT	OPT	OPT	17 lbs.
Swing-up Kitchen Console		STD	STD	STD	STD					Spare Tire & Wheel (12")	OPT	OPT	OPT	OPT							21 lbs.
Swing-out Kitchen Console						STD				Spare Tire & Wheel (13")					OPT	OPT	OPT	OPT	OPT	OPT	28 lbs.
Swing-out Utility Table								STD		Spare Tire Cover	OPT	OPT	OPT	OPT	OPT	OPT	OPT	OPT	OPT	OPT	1 lbs.
Single Dinette Table	STD	STD	STD		STD	STD				Double LP Gas Bottle Cover	OPT	OPT	OPT	OPT	OPT	OPT	OPT	OPT	OPT	OPT	1 lbs.
Two Dinette Tables				STD				STD		Single LP Gas Bottle Cover	OPT	OPT	OPT	OPT	OPT	OPT	OPT	OPT	OPT	OPT	1 lbs.
Single Dinette w/Additional 1/2 Dinette					STD		STD			Privacy Curtains		OPT	OPT	OPT	OPT	OPT	OPT	OPT	OPT	OPT	3 lbs.
Lay Down Wardrobe Closet		STD	STD		STD	STD	STD	STD	STD	West Coast Code**		OPT	OPT	OPT	OPT	OPT	OPT	OPT	OPT	OPT	
Storage For Porta-Pottie	STD	STD	STD	STD	STD	STD	STD	STD													
Two Burner Gas Range		STD						STD													
Three Burner Gas Range			STD	STD	STD		STD	STD													
Insulated Fiberglass Ice Box (35 lb.)		STD	STD	STD	STD																
Insulated Fiberglass Ice Box (70 lb.)						STD	STD	STD	STD												
10 Gallon Water Tank w/Galley Pump		STD	STD	STD	STD	STD	STD	STD	STD												
City Water Connection		STD	STD	STD	STD	STD	STD	STD	STD												
Stainless Steel Appliance(s)								STD	STD												
Color Coordinated Appliances		STD	STD	STD	STD	STD			STD												
Weather Proofed-Duplex Outside Receptacle			STD	STD	STD	STD	STD	STD	STD												
Pole Storage Compartment			STD	STD	STD	STD	STD	STD	STD												
Roof Vent		STD	STD	STD	STD	STD	STD	STD	STD												
Canvas Sides w/Removable Sections			STD	STD	STD	STD	STD	STD	STD												
Door Step					STD	STD	STD	STD	STD												
Nylon Zippers on Canvas	STD	STD	STD	STD	STD	STD	STD	STD	STD												
Decorator Drapes w/Aluminum Tracks					STD	STD	STD	STD	STD												
Side Storage Trunk						STD	STD	STD	STD												
Ceiling Mounted Light(s)		STD	STD	STD	STD	STD	STD	STD	STD												
Clear Vinyl Window-Door Side					STD	STD	STD	STD	STD												
Clear Vinyl Window-Off Door Side	STD	STD	STD	STD	STD	STD	STD	STD	STD												

*Canopy Required

**Factory Installed Only

†Add-A-Room not available on these models if heater is purchased.

The Recreational Vehicle Institute has established standards for the plumbing, electricity and L.P. gas systems for camping trailers. For your safety, all 1974 Starcraft camping trailers meet or exceed those standards. This is exemplified by the R.V.I. seal our units carry.



Starcraft camping trailers are built to conform to or exceed the codes and standards established by the Recreational Vehicle Institute and applicable local codes. Because local codes and standards sometimes require alterations in equipment, systems and/or components and because local codes are subject to change, differences in standard equipment and/or specifications for coded models are not necessarily reflected in this catalog. You are therefore advised to consult your Starcraft dealer concerning differences in coded models in areas where local codes are applicable.

The laws of your state may require that your Starcraft camping trailer have brakes. Determine the need for brakes by adding the weight of options you plan to purchase to the curb weight of the model you have chosen. Compare your camper weight, plus your anticipated cargo (load) needs to the weight laws in your state of residence. If your trailer weight exceeds the legal limit, brakes should be added to your order.

You should also familiarize yourself with the laws of states within which you plan to travel.

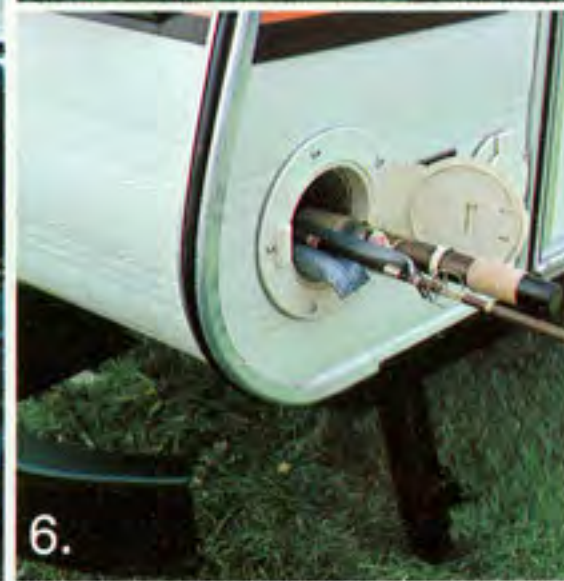
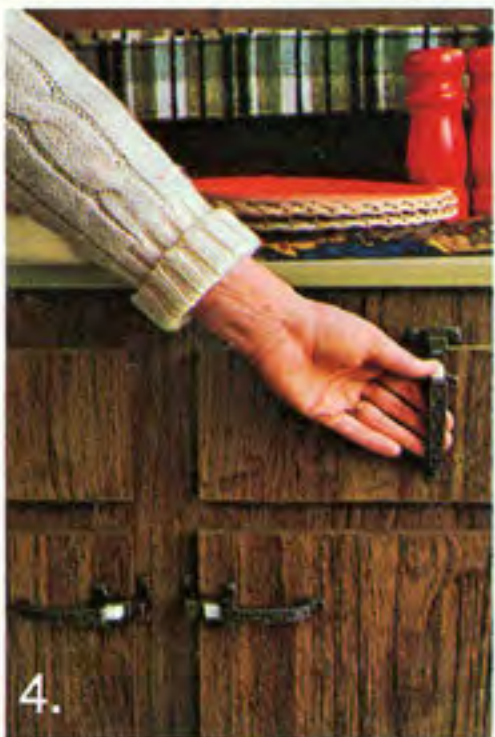

Outstanding features:

1. Rear Stoneguard.
2. Side storage trunk (Galaxies & Stardust Swinger).
3. Rugged 4" steel frame.
4. "Keep shut" cabinet latches.
5. Access to ice box with top down. Inside door latch prevents children from being locked inside.
6. Storage compartment for bunk supports and fishing rods.
7. Three-way window on off-door side including screen, clear vinyl covering and canvas with nylon zippers.
8. Crank-up lifter system lets you set up in five minutes or less.



How we build the good times into Starcraft camping trailers.



- ① Rugged 4" square channel steel frame.
- ② Rigid plywood flooring treated to resist warping.
- ③ 4-ply sandwich walls with aluminum exteriors that are strong, yet lightweight.
- ④ Fully insulated roof.
- ⑤ Heavy-duty double-stitched canvas sides.
- ⑥ Water-proof vinyl end bunk covers.*
- ⑦ Steel bumper integrated with the frame for collision protection.†††
- ⑧ Crank-up lifter system lets you set-up in 5 minutes or less.
- ⑨ Built-in stabilizing jacks.
- ⑩ Weather-proofed duplex outside receptacles.**
- ⑪ Storage for bunk supports and fishing rods.**
- ⑫ Roof vent for better air circulation.†
- ⑬ Solid screen door lets fresh air in, keeps bugs out.
- ⑭ Three-way windows on the off-door side including screen, clear vinyl covering and curtains or canvas with nylon zippers.
- ⑮ Counter with sink at a convenient working height.*
- ⑯ Stain-resistant reversible cushions.
- ⑰ Ice box (accessible from the door even when the camper top is down).*
- ⑱ Dinette that converts into a double bed.
- ⑲ Hydraulic surge brakes for safe, sure stops.††
- ⑳ Heavy-duty 2" coupler.
- ㉑ Leaf-spring suspension for easy towing.

Plus these features not shown:

- 10 gal. water tank with galley pump and inlet.*
- City water hook-up.* • 110 volt power cord.* • 110/12 volt electric converter.* • Optional fresh air vented heater.* • Gas range.*

*Not available on Starlite. **Not available on Starflite or Starlite.

†Optional on Starflite and Starlite. ††Standard on Galaxy and optional on all other models. †††Optional on Starlite.



Galaxy.

More room, comfort and convenience than any other camper at any other price.

No other camping trailer gives you quite so much as our Galaxy. In fact, few even come close. Its upholstery and cabinetry have the look and feel of fine furniture. New raised decorator door and drawer fronts add even more beauty.

And just look at the standard convenience features Galaxy offers. A convertible dinette and big, soft bunks that sleep six, seven or eight (depending on the model you choose). A wardrobe and side trunk for storage. An ice box that's accessible even with the top down. A complete kitchen at a comfortable working height. And, if you like to cook outdoors for a change, there's a Galaxy Swinger model with a swing-out console kitchen that lets you cook indoors or out.

That's Starcraftsmanship.

Left — Galaxy Swinger interior.
 Top, right — Galaxy 8 interior.
 Bottom, center — Galaxy Swinger.
 Bottom, right — New decorator cabinetry.

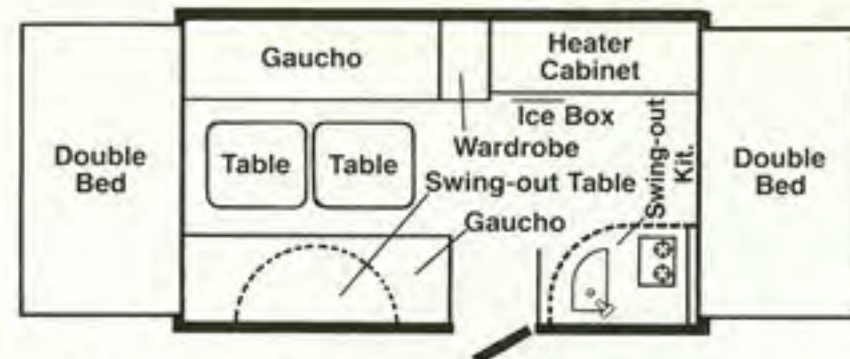

Galaxy Swinger (see Galaxy 8 specifications below.)

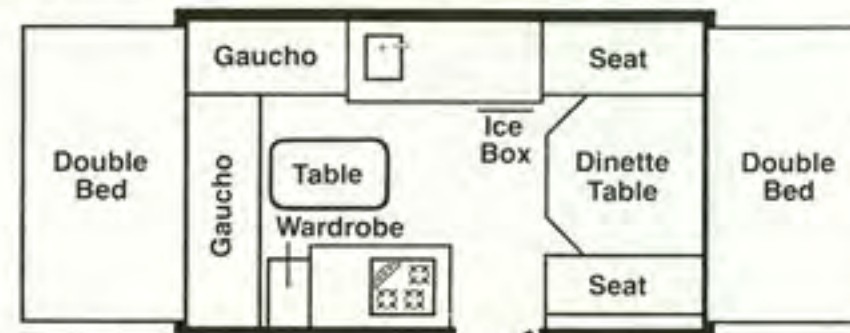

Galaxy 8 Dimensions/Weights

Closed for Traveling: Length 16'8"/Width 6'11"/Height 4'8"
 Living Area Erected: Length 20'0"/Width 6'4"/Height 6'6"
 Bunk Sizes — Extended Ends: 48"x72" Dinette/Gauchito: 44"x76"
 Tire Rating: 1230 lbs. at 36 PSI Coupler Size: 2"
 Trailer — *CW: 1730 lbs. **GVWR: 2760 lbs. (Swinger 1765/2745)
 Hitch — *CW: 240 lbs. **GVWR: 480 lbs. (Swinger 250/425)
 Rated Cargo Load (all options installed): 750 lbs.

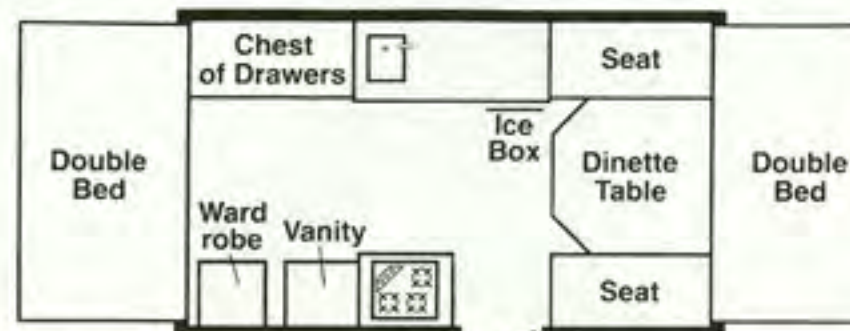

Galaxy 6 Dimensions/Weights

Closed for Traveling: Length 16'8"/Width 6'11"/Height 4'8"
 Living Area Erected: Length 20'0"/Width 6'4"/Height 6'6"
 Bunk Sizes — Extended Ends: 48"x72" Dinette: 44"x76"
 Tire Rating: 1230 lbs. at 36 PSI Coupler Size: 2"
 Trailer — *CW: 1725 lbs. **GVWR: 2695 lbs.
 Hitch — *CW: 270 lbs. **GVWR: 455 lbs.
 Rated Cargo Load (all options installed): 750 lbs.
 *Curb weight is with systems dry and no optional equipment installed.
 **Gross Vehicle Weight Rating consists of camper weight plus all options and rated cargo load.

Actual weight of any Starcraft camper will vary based on the specific options it contains.





Stardust.

Luxury and convenience
for the taking.

You take luxury and convenience wherever you go when you take a Stardust camper. Because Starcraftsmanship makes Stardust one of the most complete campers ever built.

For instance, depending on the model, there's room to sleep a family of six or eight on big bunks and a convertible dinette. An additional half dinette provides extra dining space*. There's a wardrobe for your clothes. An ice box for all the food you'll want to take with you. Plus a range and sink in the swing-up cabinet. And, if you'd like to cook outdoors for a change, there's a Stardust Swinger model with a swing-out console kitchen that lets you cook indoors or out.

That's Starcraftsmanship.



Left — Stardust 8 interior.
Top, center — Stardust Swinger.
Top, right — Stardust Swinger swing-out kitchen.
Bottom, right — Stardust Swinger interior.

*Additional half dinette on Stardust 8 only.

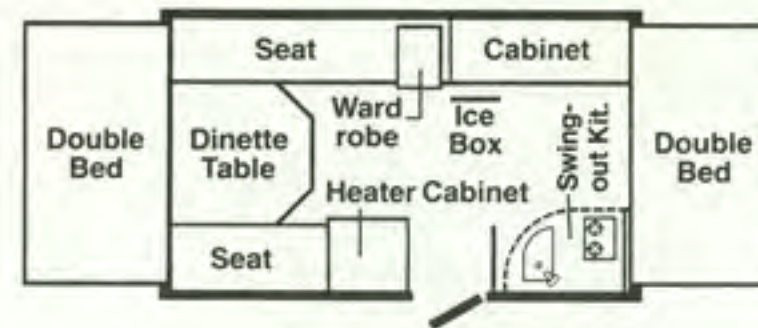

Stardust Swinger Dimensions/Weights

Closed for Traveling: Length 14'4"/Width 6'11"/Height 4'8"
Living Area Erected: Length 18'0"/Width 6'4"/Height 6'6"
Bunk Sizes — Extended Ends: 48"x72" Dinette: 40"x76"
Tire Rating: 1230 lbs. at 36 PSI Coupler Size: 2"
Trailer — *CW: 1495 lbs. **GVWR: 2530 lbs.
Hitch — *CW: 195 lbs. **GVWR: 360 lbs.
Rated Cargo Load (all options installed): 850 lbs.

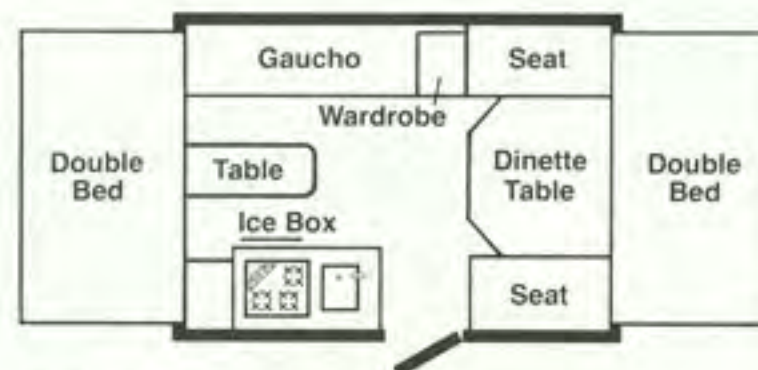

Stardust 8 Dimensions/Weights

Closed for Traveling: Length 14'4"/Width 6'11"/Height 4'8"
Living Area Erected: Length 18'0"/Width 6'4"/Height 6'6"
Bunk Sizes — Extended Ends: 48"x72" Dinette: 40"x76"
Gauchó: 40"x76"
Tire Rating: 1230 lbs. at 36 PSI Coupler Size: 2"
Trailer — *CW: 1510 lbs. **GVWR: 2615 lbs.
Hitch — *CW: 200 lbs. **GVWR: 405 lbs.
Rated Cargo Load (all options installed): 850 lbs.

*Curb weight is with systems dry and no optional equipment installed.
**Gross Vehicle Weight Rating consists of camper weight plus all options and rated cargo load.

Actual weight of any Starcraft camper will vary based on the specific options it contains.





Starmaster.

No other camper gives you this kind of room and comfort for the money. Not one.

It's true. If you need a big camper for a big family and you don't have a big budget, Starmaster is the only camper made that has the kind of value, comfort and features your family needs. Like convertible dinette(s) and bunks to sleep six (Starmaster 6) or eight (Starmaster 8). An ice box that's within reach of the door, so you don't have to set up camp to get the kids a cold drink.

There's storage space for everything a big family needs to take along. And a kitchen console that swings up to a convenient working height. With features like this, it's no wonder Starmaster is our most popular camper. **That's Starcraftsmanship.**



Left — Starmaster 8 interior.
 Top, right — Starmaster 6 interior.
 Bottom, right — Starmaster 8.

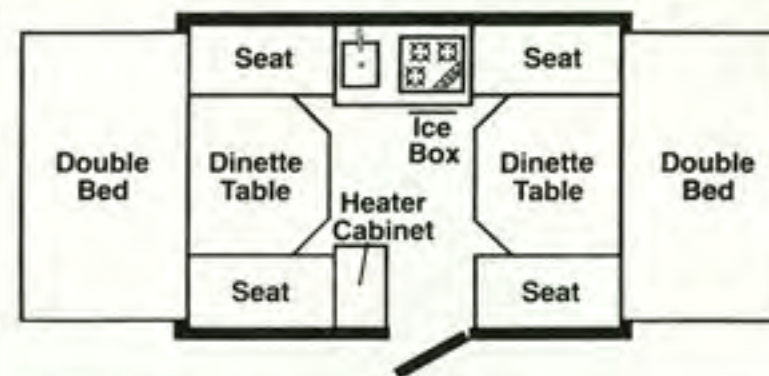

Starmaster 8 Dimensions/Weights

Closed for Traveling: Length 14'4"/Width 6'11"/Height 4'6"
 Living Area Erected: Length 18'0"/Width 6'4"/Height 6'5"
 Bunk Sizes — Extended Ends: 48"x72" Dinettes: 40"x76"
 Tire Rating: 1045 lbs. at 80 PSI Coupler Size: 2"
 Trailer — *CW: 1440 lbs. **GVWR: 2420 lbs.
 Hitch — *CW: 190 lbs. **GVWR: 370 lbs.
 Rated Cargo Load (all options installed): 700 lbs.

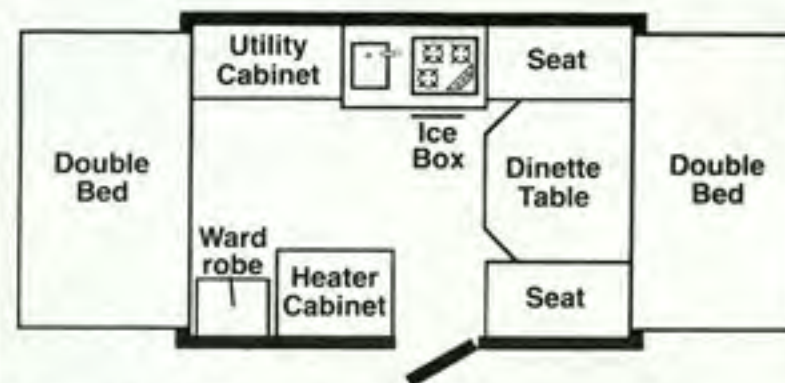

Starmaster 6 Dimensions/Weights

Closed for Traveling: Length 14'4"/Width 6'11"/Height 4'6"
 Living Area Erected: Length 18'0"/Width 6'4"/Height 6'5"
 Bunk Sizes — Extended Ends: 48"x72" Dinette: 40"x76"
 Tire Rating: 1045 lbs. at 80 PSI Coupler Size: 2"
 Trailer — *CW: 1405 lbs. **GVWR: 2360 lbs.
 Hitch — *CW: 180 lbs. **GVWR: 355 lbs.
 Rated Cargo Load (all options installed): 700 lbs.

*Curb weight is with systems dry and no optional equipment installed.
 **Gross Vehicle Weight Rating consists of camper weight plus all options and rated cargo load.

Actual weight of any Starcraft camper will vary based on the specific options it contains.





Starflite and Starlite.

Economy campers that don't economize on quality and comfort.

Just because a camping trailer costs a little less, we don't think it should give you any less of a good time. That's why we designed Starflite and Starlite.

Starflite offers many of the features of our more expensive campers like a complete kitchen with range, sink, ice box and counter. Starflite has a swing-up wardrobe, too, plus a 110/12 volt electric converter system.

Starlite is made for the camping purist who wants the basics without sacrificing Starcraft quality. It has a large utility cabinet for a camping stove, clothes, luggage or weeks of other camping gear.

Both trailers have room to sleep six comfortably. And like all Starcraft campers, they'll keep on giving you a good time for years to come.

That's Starcraftsmanship.

Left — Starflite 6 interior.

Top, right — Starlite 6.

Bottom, right — Starlite 6 interior.

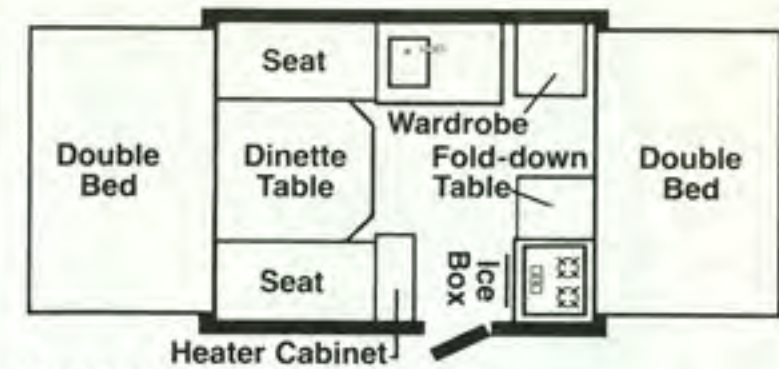

Starflite 6 Dimensions/Weights

Closed for Traveling: Length 12'4"/Width 6'11"/Height 4'6"
 Living Area Erected: Length 16'0"/Width 6'4"/Height 6'5"
 Bunk Sizes — Extended Ends: 48"x72" Dinette: 40"x76"
 Tire Rating: 1045 lbs. at 80 PSI Coupler Size: 2"
 Trailer — *CW: 1245 lbs. **GVWR: 2020 lbs.
 Hitch — *CW: 190 lbs. **GVWR: 280 lbs.
 Rated Cargo Load (all options installed): 600 lbs.

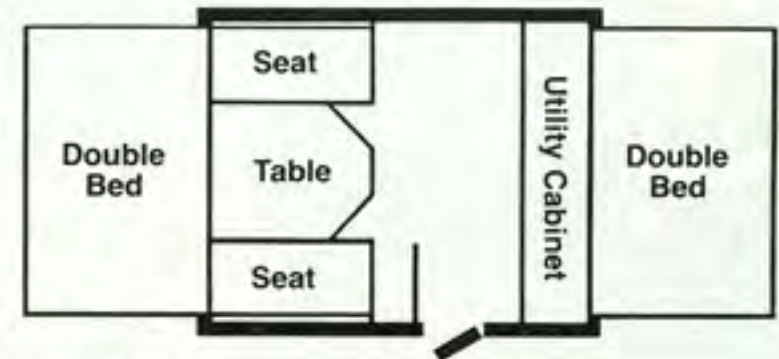

Starlite 6 Dimensions/Weights

Closed for Traveling: Length 12'4"/Width 6'11"/Height 4'6"
 Living Area Erected: Length 16'0"/Width 6'4"/Height 6'5"
 Bunk Sizes — Extended Ends: 48"x72" Dinette: 40"x76"
 Tire Rating: 1045 lbs. at 80 PSI Coupler Size: 2"
 Trailer — *CW: 1115 lbs. **GVWR: 1990 lbs.
 Hitch — *CW: 185 lbs. **GVWR: 250 lbs.
 Rated Cargo Load (all options installed): 750 lbs.

*Curb weight is with systems dry and no optional equipment installed.

**Gross Vehicle Weight Rating consists of camper weight plus all options and rated cargo load.

Actual weight of any Starcraft camper will vary based on the specific options it contains.

Starcraftsmanship guarantees the good times.

Our campers are trouble-free.

So is our warranty. Starcraft campers are made so well, it's doubtful that you'll ever have to use the warranty. That's nice for both of us. We have fewer warranty claims to handle. And you have more good times.

But if you ever do have a problem with your Starcraft camping trailer, our dealers will take care of it immediately. Period. You see, our campers are made with Starcraftsmanship. And we're so sure of their quality that we back each one with a full 12 month warranty against defects in materials and workmanship. (Ask your dealer for the complete Starcraft warranty.)

That's Starcraftsmanship.

Starcraft Camper Club.

Good times. Good friends. To make owning a Starcraft even more enjoyable, you have an opportunity to join the Starcraft Camper Club. The club offers you good fellowship and organized activities on the state and national level. A national rally is held each year, along with dozens of local rallies. Ask your dealer about joining the Starcraft Camper Club today!

That's Starcraftsmanship.



All product illustrations and specifications are based on information available at the time of publication. Some of the equipment shown separately and on product illustrations is optional at extra cost. Because of a continuing policy of product improvement and a desire to provide better consumer value, Starcraft reserves the right to make changes without notice or obligation. Your local Starcraft dealer will have exact specifications and product offerings at the time you buy.

STARCRRAFT

