

STARCRAFT '77

PERFORMANCE YOU
CAN COUNT ON.



STARCRAFT CAMPERS

STARCRAFT

PERFORMANCE YOU
CAN COUNT ON.

At Starcraft we build in performance you can count on. We make sure that every camper we build is safe, reliable and easy for you to use. And then we finish it with a touch of luxury. We engineer our campers, from the start, to save you money. And we build them, from the axles up, to last.

We Don't Believe In Compromise. We know there is no single camper that's right for every family under all conditions. We don't try to build do-everything campers that do nothing well. Instead we make 11 different campers: So you can have the fully equipped, luxury camper that you've always dreamed of. Can choose from one of several simpler, more economical, full-sized models. Or one of

our handy compacts. We think you should have the choice.

Ruggedly Built, Finely Finished. Our campers are built to take a beating, but we don't believe they have to look like trucks. Even our most economical models are finished with the glow of wood-grained cabinets, and decorator-coordinated fabrics. Every camper we make has a handsomely patterned—and long-lasting—vinyl floor and richly colored formica counter tops. And our most luxurious campers are truly compact cottages on wheels. Appointed with fine carpentry on their kitchen cabinets. Fitted with brass-finished hinges and handles on drawers and closets. And equipped, as optional extras, with every-

thing from spare tires and awnings to gas heaters and electric refrigerators.

Starcraft Insists On Safety. No camper is a wise investment if it isn't a safe one. That's why Starcraft meets or exceeds the Recreation Vehicle Industry Association's standards for safety. Why our 110-volt electrical system is grounded and has its own circuit breaker. And why flame-retardant materials were standard on Starcraft campers before they were required by law.



Our luxurious full-sized Galaxy 8 and handy compact Starlette XL. Two of Starcraft's 11 different camper models. There's a Starcraft camper you can afford that's suitable to your family's needs.



The Starflite, like all Starcraft campers, comes with automotive-type suspension, tough leaf springs and Goodyear tires.

A camping trailer should also be easy and safe to tow. It should be built to cope with rough and twisty backwoods roads. And to hold up where repairmen are hard to find. That's why Starcraft campers have an automotive type of suspension. With tough leaf springs for smoothness. Goodyear tires. And an extra-hefty welded steel frame.

Starcraft Builds In Economy. Our campers are designed to save you money. That's one of the reasons why we make so many models. So you don't have to buy more camper than you need. But we also save you money in the way we build our campers.

We use a lot of aluminum to save on weight. It makes our campers easy to tow and costs you less to tow them. And as the nation's largest builder of aluminum boats, we know how to take advantage of aluminum's extraordinary strength.

We also use materials that are designed to last. Corrosion-resistant metals. Rugged vinyl flooring. And a 10/10 duck canvas, which is noted for its toughness. This saves you money on repairs. And helps give Starcraft campers the highest resale value in the business.



The Galaxy's swing-out kitchen. Use either indoors or outdoors for cookouts on the road.



Over 2,000 members of the Starcraft Camper Club participated in the 1975 Rally near Milaca, Minnesota. Campers came from Canada and thirty-one states to enjoy the festivities.

Why Starcraft Campers Are The World's Best Sellers. One out of every three campers on the road today is a Starcraft. That's more, by far, than any other make of camper. Why? Because Starcraft has a reputation to live up to.

A reputation for innovative engineer-

ing. We pioneered the crank-up lifter system, for example. We were first with the swing-out kitchen. And today we offer a range of features that no other camping trailer can match.

We have a reputation for dedicated service, too. With more dealers from coast to coast and in Canada than any other camper manufacturer.

And finally, we have a reputation for performance you can count on. We sell more campers because they work, they last for years and they hold up when the going's rough.

(Left) Starcraft's easy setup system: a single crank sets up the roof and sidewalls—and locks them securely into place. Then release a simple latch on each of the stabilizing jacks. It only takes five minutes, and your camper is ready.



GALAXY, STARDUST

CAMPING
TOUCH OF

The Galaxy is the largest and most fully featured camper Starcraft makes. We think it's the finest camper you can buy at any price. And it's not the most expensive camper on the market.

One hundred and thirty square feet of living space, a full dinette for eight, a folding wardrobe and lots of extra storage make the Galaxy a pleasure to live in. Wood paneling for cabinets and brass-finished drawer pulls and handles add to its handsome finish. And the long list of standard equipment includes a three-burner propane stove, a side-opening 75-lb. icebox, Herculon fabric upholstery and fire-retardant curtains.



Starcraft's Stardust 8—Galaxy quality and luxury in a slightly smaller camper that sleeps 8.

Three models are offered: The Galaxy 8 with room for eight adults to sleep. The even roomier Galaxy 6. And a Galaxy Swinger with room for seven and our famous swing-out kitchen. A host of options are offered, too: boat rack, spare-tire holder, gas heater and an electric refrigerator. Starcraft's combination of canvas

rooms, canopy tops and screen enclosures gives you extra room for dining or camping out. There is even an optional shower available on the Galaxy 6 model.

The Stardust is an equally luxurious camper on a slightly smaller scale. It's made for those who want the quality of our Galaxy but don't require its extra space. For families who'd rather have a smaller, less expensive camper.

The Stardust is as well equipped as the Galaxy. And most of the same accessories are available. We make a Stardust Swinger, with a swing-out kitchen, a big dinette and lots of space for six adults. And there's also a Stardust designed for eight. They're both as big as all but the largest campers on the road. And as finely finished as any camper we make.

The living area of the Starcraft Galaxy Swinger closed is only 12 feet long and 6'11" wide. Compact and easy to tow. Open, it grows to 21 feet long with deep foam bunks that sleep seven.



(Right) Galaxy Swinger: Starcraft's largest and most fully featured camper with over 130 square feet of living space.



WITH A
LUXURY.

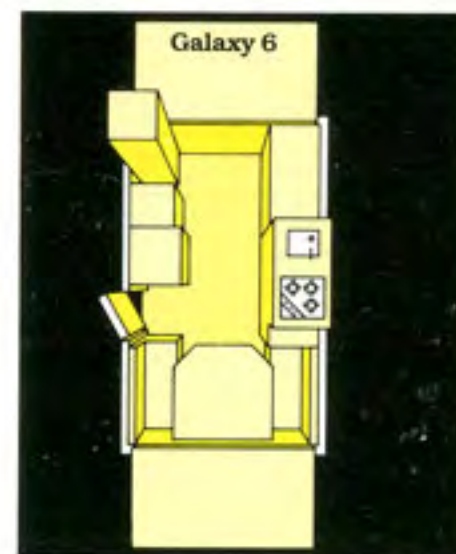
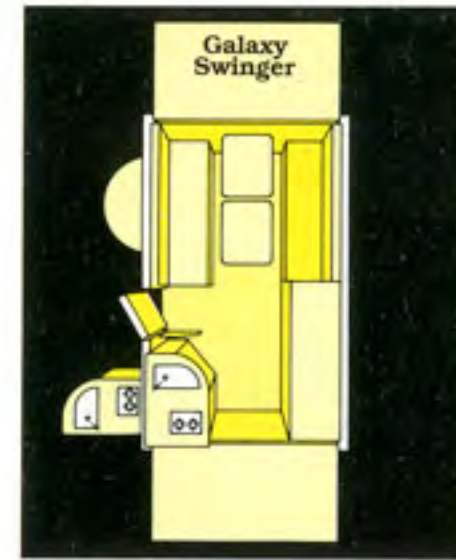
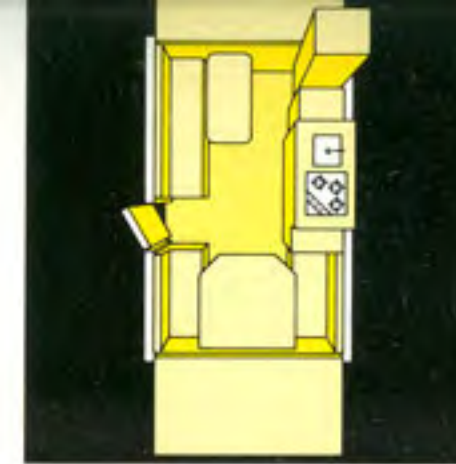

(Below) Galaxy Swinger. The kitchen "swings out." You can be part of the outdoor activities while preparing meals and snacks.



STARMASTER

THE MOST POPULAR
CAMPER EVER BUILT.

The Starmaster is a bit of a Starcraft classic. A full-sized camper that so sensibly combines economy and performance that it's the best selling camping trailer in America. And has been since we started building it in 1964.

Full-sized with 120 square feet of living space when opened, the Starmaster closes down to an easy-handling 10' x 6' box for trailering. It features nearly all of Starcraft's major innovations. Our easy lifter system. The 12/110-volt electrical converter. Our automotive-type suspension. And it sells for a surprisingly modest price.

What's more, the Starmaster is not a stripped-out cut-rate model. Decorator-coordinated fabrics, for example, come as



Three inches of polyurethane foam on the beds of the Starcraft Starmaster help make sleeping or relaxing pure pleasure.

standard equipment. Made from Herculon so they're resistant to stains. The bunks are made with a full three inches of polyurethane foam. And like most Starcraft campers, the Starmaster is available with bunks for eight, if you want to bring the gang along. Or with beds for six if you'd rather have the extra space.



The Starcraft patented swing-up kitchen adds to the convenience in the Starmaster.



The Starcraft Starmaster—America's largest-selling camping trailer. Sets up in 5 minutes and then you can relax.



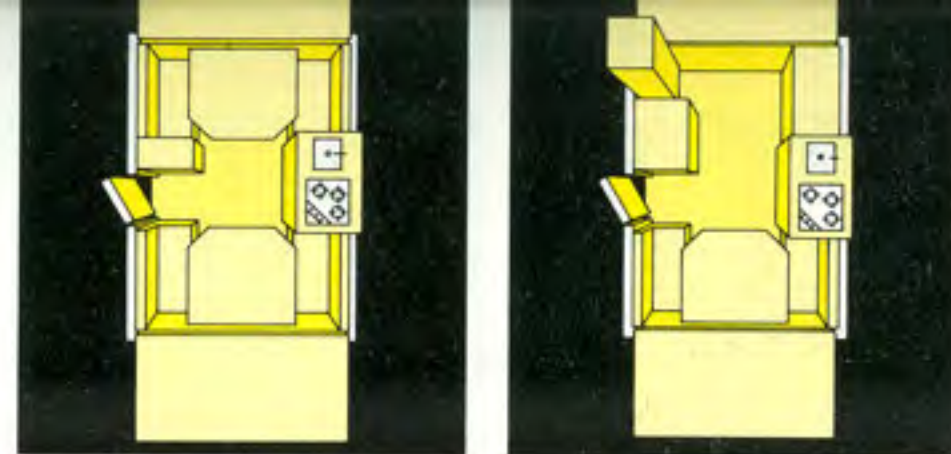

The Starmaster dinette seats four comfortably and at night converts quickly to a full-sized bed.

(Left) The Starmaster 6 interior provides 120 square feet of living space. And a combination of most-wanted features at a very sensible price.



Starmaster 6's clothes wardrobe—just part of the extensive storage capacity of this camper.

STARFLITE, STARLITE

COMPACT
CAMPER

Not everyone needs one of Starcraft's full-sized camping trailers. Some campers have smaller families. Others like to travel light and bring along their camping gear. And almost everyone is interested in economy. So Starcraft builds two smaller, lighter and less expensive campers tailored to your needs. They have the convenience and rock-solid construction of our larger campers. They come with many of the famous Starcraft features. But they're smaller, easier to handle, and easier to pay for.

The Starflite is a sturdy full-featured Starcraft in a smaller size. It comes with a propane stove, a 35-lb. icebox and a built-in sink and water tank. The same Herculon fabrics used in our larger campers are standard in the Starflite. The same three-inch-thick foam mattresses. The same rugged welded steel frame. And there's plenty of room inside for six adults to sleep and dine in comfort.

The Starlite 7 was built for campers moving up from tents. It gives you over 100 sq. ft. of living space—and it's ready to move into before a tent of equal size is even unpacked from the car. The Starlite is an economical seven-sleeper without a built-in galley. So you can move up to a Starcraft and still use all your camping gear.



Starcraft's Starflite 6. It can carry almost 800 pounds of extra cargo—all the gear that dedicated outdoor people need.



The full-featured Starcraft Starflite 6. The swing-up galley makes cooking and cleaning up less of a chore, so the whole family can quickly get back to all their outdoor activities.



LESS EXPENSIVE
TAILORED TO YOUR NEEDS.

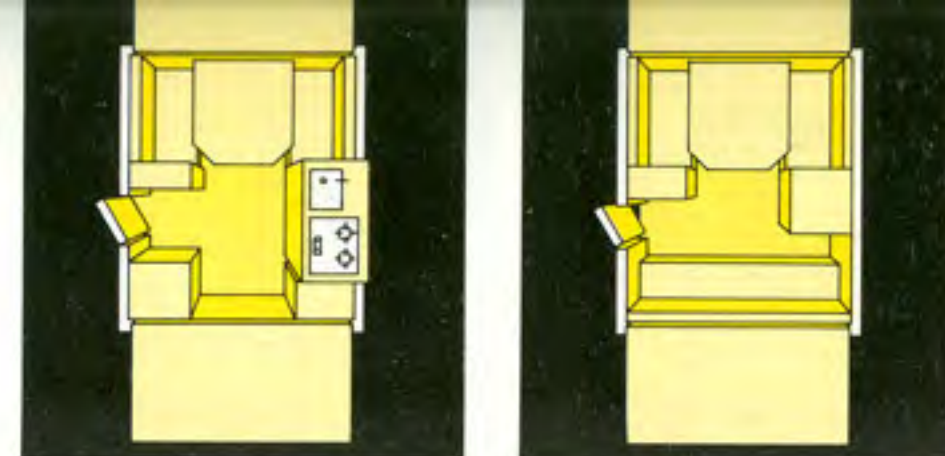

With the clothes bar built into both the Starlette and the Starflite 6, you just leave your clothes in place when you crank down the top.

(Left) The Starcraft Starflite 6. Its living area is over 6 feet wide by 16 feet long, more than 100 sq. ft. It sleeps six.

Like every camper we build, our smaller Starcrafts are a breeze to set up. A single crank sets up the roof and sidewalls—and locks them securely into place. The built-in screen door drops from the ceiling and snaps into position. Each of the stabilizing jacks extends and locks when you release a simple latch. It only takes five minutes, and your camper is ready to move into.

STARLETTE XL

FOR TRAVELING LIGHT.

The Starlette is the lightest camper made by Starcraft. It is, in fact, one of the lightest hardtop camping trailers you can buy. We built it to tow with ease behind the smallest compact car. And we made it for those who want to travel light. For threading a narrow logging trail or nestling into secluded backwoods camping spots.

But we also gave Starlette the rugged durability and convenience that is the mark of every Starcraft camper.

The Starlette standard weighs a remarkable 850 lbs. And yet there's room inside to sleep four adults in easy comfort. And six in a pinch using the fold-down dinette. And the camper is tough

enough to carry an extra 400 pounds of camping gear. Enough to bring along a pair of bicycles. Or to carry a lightweight fishing boat on top.

The Starlette XL offers the same light weight (it weighs only 975 lbs.) with a full galley—with a stainless sink, a ten-gallon water tank, a 25-lb. fiberglass-lined icebox and a two-burner propane stove. And the living area's 7 feet wide and more than 13 feet long. With two 6' by 4' double beds. And 6'2" headroom.

Like every other Starcraft camper, the super-light Starlettes are built to last. They have automotive-type suspensions. Goodyear tires. And sturdy welded steel frames. At a surprisingly light price.

The Starlette XL interior features a full galley: stainless sink, a 25-pound fiberglass-lined icebox and a two-burner propane stove. The dinette seats 4 comfortably and at night converts to a full-size bed.



All the gear—over 400 pounds—that's so much a part of camping and the outdoor life will easily stow in and on this lightweight Starcraft Starlette XL.



(Right) In spite of its small size when closed, the Starcraft Starlette XL opens to sleep six. The living area is 7 feet wide and 13 feet long and has 6'2" headroom.



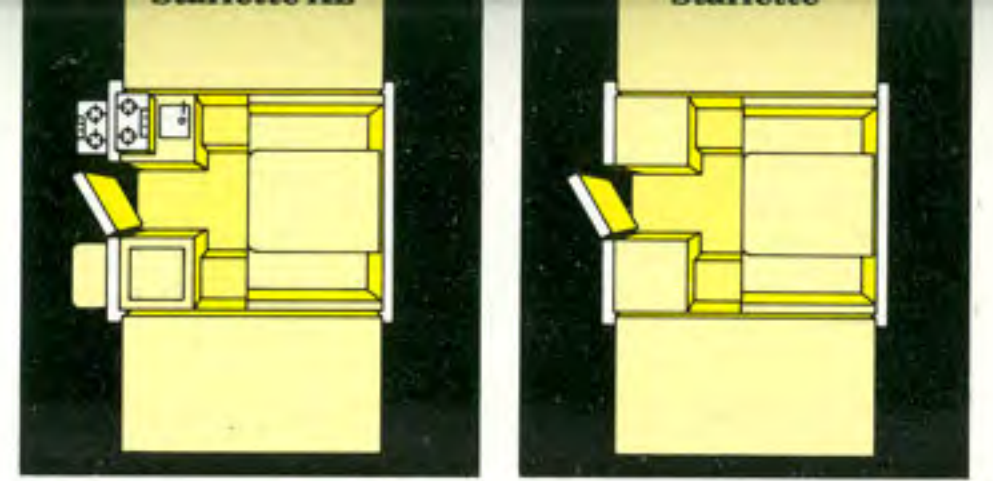

Starcraft's lightest camper is built to tow with ease behind a compact car. And it folds so low that no special towing mirrors are required.

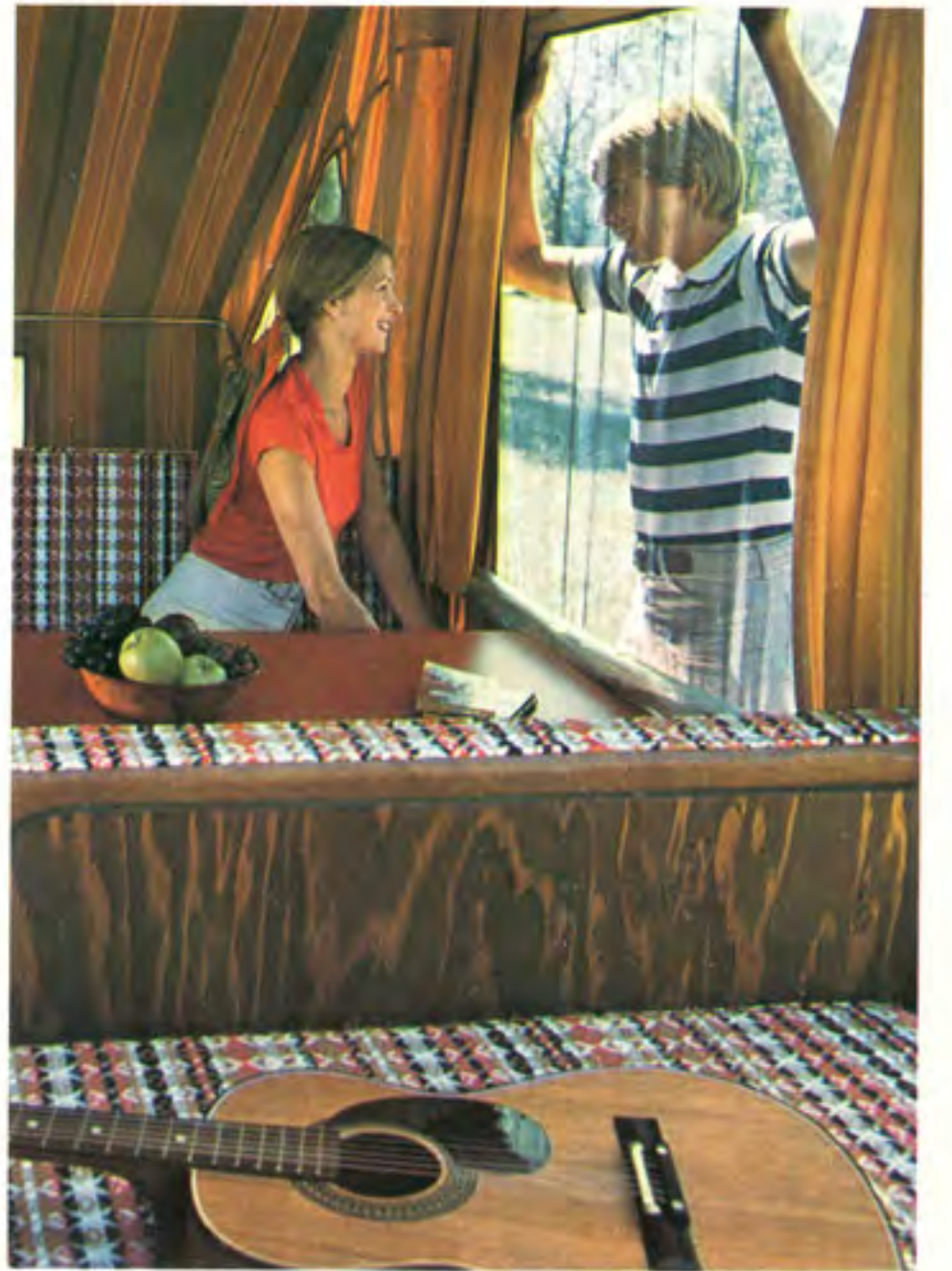

Starlette features three-way windows: screens, zippered clear-vinyl covering and curtains.

HOW STARCRAFT CAMPERS A

Starcraft campers are rugged outdoor vehicles. Not classy campground toys. Because we believe a camper should be tough enough to get you away from trailer camps and superhighways. And built with the quality to last for season after season.

THE SIDEWALLS

We use only 10/10 duck canvas for our sidewalls. It's rot and mildew resistant and lasts for years. And if a section is damaged it easily unzips. So canvas parts can be replaced without replacing the entire sidewall. On the off-door side of every Starcraft camper we put in a three-way window. You can open it up for ventilation, or zip the clear vinyl covering closed if it's cold or wet. At night the window closes with canvas or decorator curtains for privacy.

THE FRAME AND RUNNING GEAR

Four-inch steel channel bars are welded together to form a Starcraft camper's frame. Some other campers make do with three-inch bars. Built-in stabilizing jacks are standard. A single lever is all you need to set them up. The heavy-duty 2" coupler system makes towing safer and more secure. And a tough steel frame-mounted bumper that's available on most models helps to protect you from the other guy.

THE ROOF

Starcraft quality starts at the top. Wooden braces, thick insulation and a corrosion-resistant aluminum outer skin make a roof that's light in weight but extraordinarily strong. Strong enough, in fact, to support a lightweight fishing boat or canoe. The roof is curved to add a bit of extra headroom underneath and to do away with puddles. And we also curve the canvas end-bunk canopies. So you can leave the window panels open without letting in the rain or dew.

25 ft. 110 volt power cord.

Aluminum bunk frames and glides.

THE CAMPER BODY

The rigid body of a Starcraft camper is protected with a gleaming hard-enameled aluminum skin. It's strengthened with two plywood panels, and thickly insulated for warmth and quiet. Even the camper door is insulated. And it opens to make supplies accessible even when the camper is closed.

Patented crank-up lifter system with safety catch lets you set up in 5 minutes. Or less.

Easy-adjust spring-loaded screen door for quick setups.

Waterproof one-piece vinyl end bunk covers.

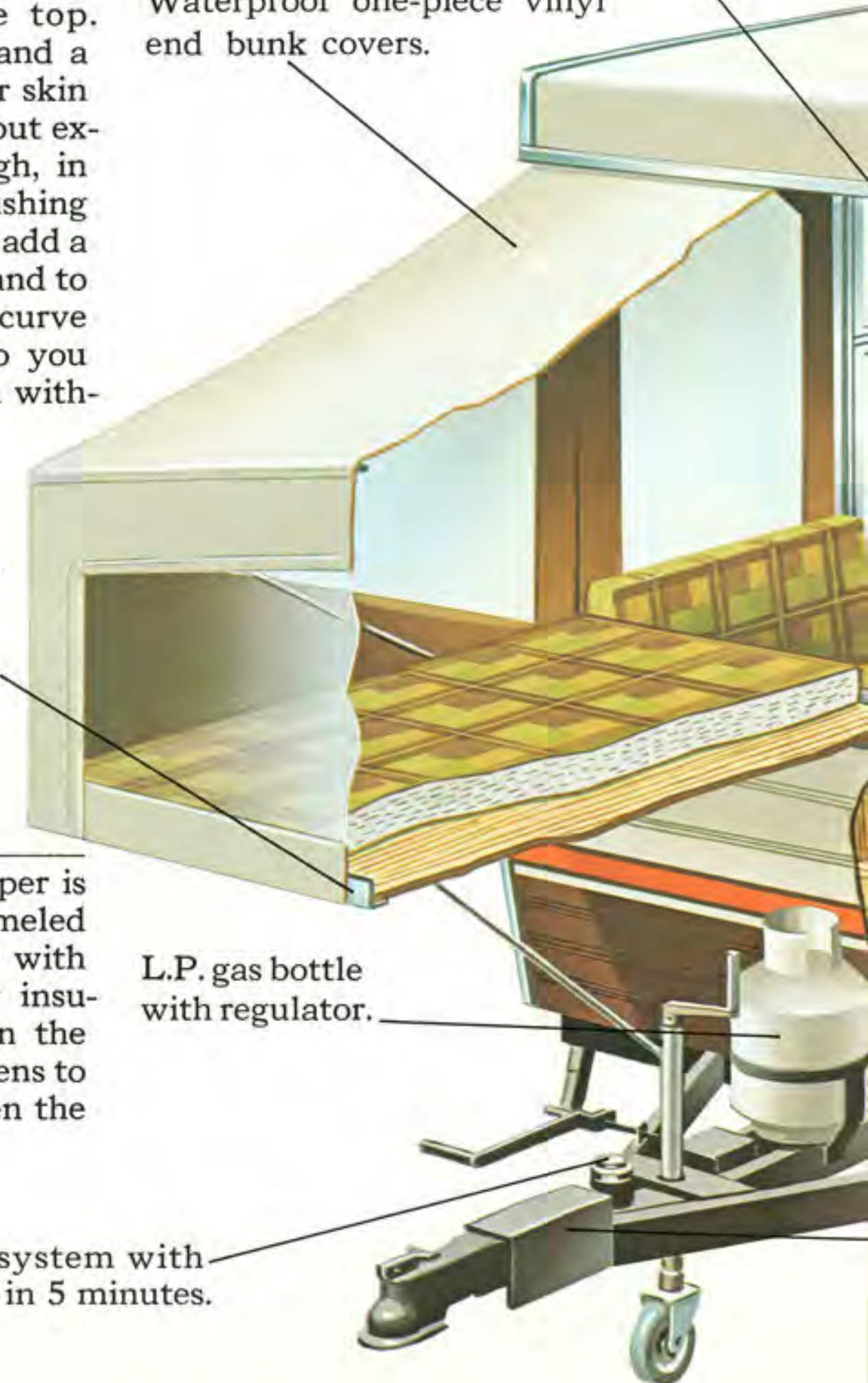

RE BUILT TO GO THE DISTANCE.

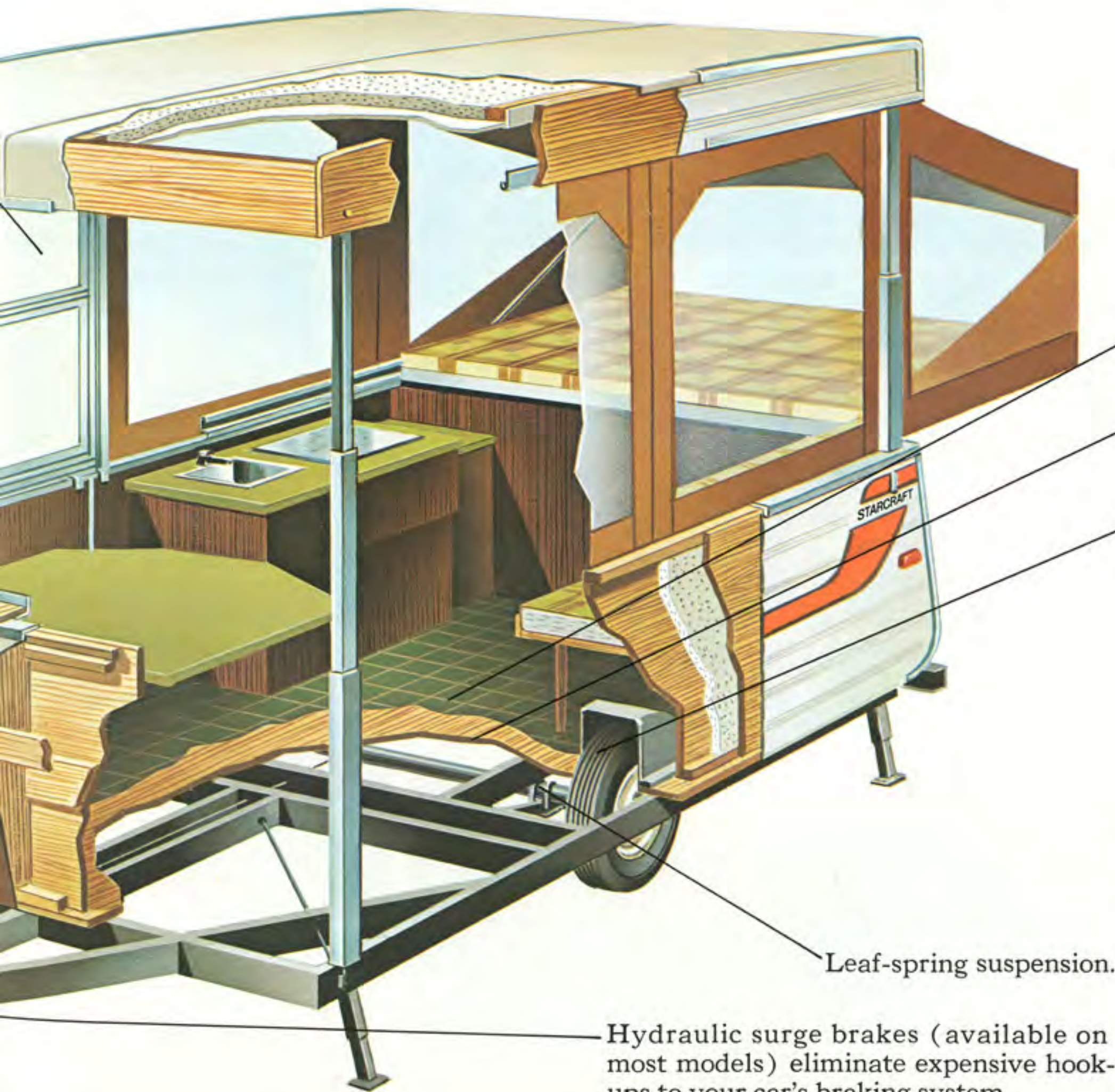

Weatherproof duplex outside receptacle.

Storage for bunk supports and fishing rods.

10 gallon water tank with galley pump and city water connection.

110/12 volt electric converter gives you electricity from campground outlet or car battery.

One-piece vinyl floor covering.

Rigid plywood flooring treated to resist warping.

Automotive-type 12" or 13" wheels for easier towing.

Leaf-spring suspension.

Hydraulic surge brakes (available on most models) eliminate expensive hook-ups to your car's braking system.

Starcraft has an Owner Protection Service (OPS) that assures you of expert service after the sale. So, if you have a problem with your Starcraft camper, our dealers will fix it. No red tape. No run-around.

You see, we're so sure of the quality we build into our campers that we back each one with a limited 12-month warranty against defects in materials and workmanship. (Ask your dealer for complete details.)

Features shown not necessarily available on all models. Consult standards and options for actual offerings on each model.

PERFORMANCE YOU CAN COUNT



Galaxy Swinger

- Exterior Closed:**
 Length (Overall) 16'8"
 (Minus Hitch & Bumper) 12'
 Width 6'11"/Height 4'8 1/2"
- Interior Erected:**
 Length 21'/Width 6'4"
 Height 6'6 1/2"
- Bunk Sizes:**
 Extended Ends 54" x 72"
 Gaucho 44" x 76"
- Tire Size:**
 6:50 x 13"/Load Range C
- Tire Rating:**
 1340 lbs. at 60 psi
- Coupler Size: 2"**
- *Curb Weight:**
 Trailer 1745 lbs.
 Hitch 225 lbs.
- *GVWR:**
 Trailer 2680 lbs.
 Hitch 300 lbs.
- **Rated Cargo Load: 935 lbs.**

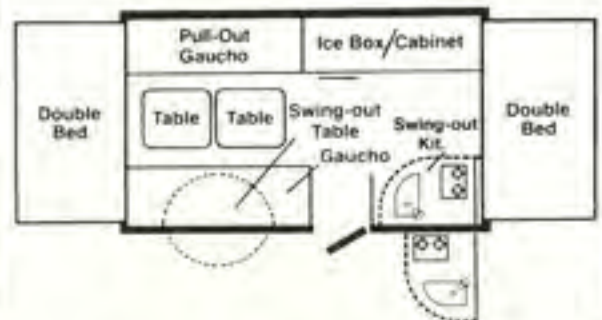

Galaxy 8

- Exterior Closed:**
 Length (Overall) 16'8"
 (Minus Hitch & Bumper) 12'
 Width 6'11"/Height 4'8 1/2"
- Interior Erected:**
 Length 21'/Width 6'4"
 Height 6'6 1/2"
- Bunk Sizes:**
 Extended Ends 54" x 72"
 U-Shaped Dinette 44" x 76"
- Tire Size:**
 6:50 x 13"/Load Range C
- Tire Rating:**
 1340 lbs. at 60 psi
- Coupler Size: 2"**
- *Curb Weight:**
 Trailer 1700 lbs.
 Hitch 215 lbs.
- *GVWR:**
 Trailer 2680 lbs.
 Hitch 300 lbs.
- **Rated Cargo Load: 930 lbs.**

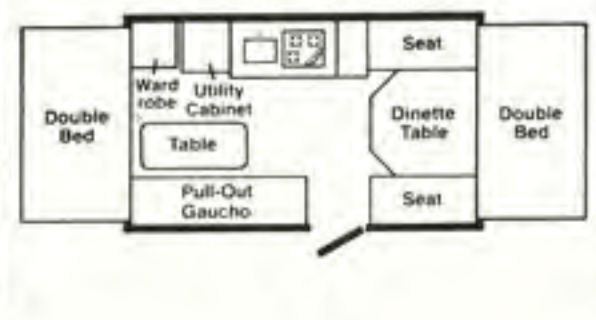

Galaxy 6

- Exterior Closed:**
 Length (Overall) 16'8"
 (Minus Hitch & Bumper) 12'
 Width 6'11"/Height 4'8 1/2"
- Interior Erected:**
 Length 21'/Width 6'4"
 Height 6'6 1/2"
- Bunk Sizes:**
 Extended Ends 54" x 72"
 Dinette 44" x 76"
- Tire Size:**
 6:50 x 13"/Load Range C
- Tire Rating:**
 1340 lbs. at 60 psi
- Coupler Size: 2"**
- *Curb Weight:**
 Trailer 1695 lbs.
 Hitch 220 lbs.
- *GVWR:**
 Trailer 2680 lbs.
 Hitch 300 lbs.
- **Rated Cargo Load: 985 lbs.**

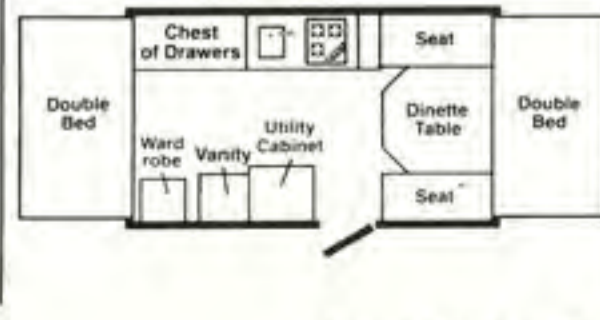

Stardust Swinger

- Exterior Closed:**
 Length (Overall) 14'4"
 (Minus Hitch & Bumper) 10'
 Width 6'11"/Height 4'8"
- Interior Erected:**
 Length 19'/Width 6'4"
 Height 6'5"
- Bunk Sizes:**
 Extended Ends 54" x 72"
 Dinette 40" x 76"
- Tire Size:**
 6:50 x 13"/Load Range C
- Tire Rating:**
 1340 lbs. at 60 psi
- Coupler Size: 2"**
- *Curb Weight:**
 Trailer 1490 lbs.
 Hitch 225 lbs.
- *GVWR:**
 Trailer 2680 lbs.
 Hitch 300 lbs.
- **Rated Cargo Load: 1190 lbs.**

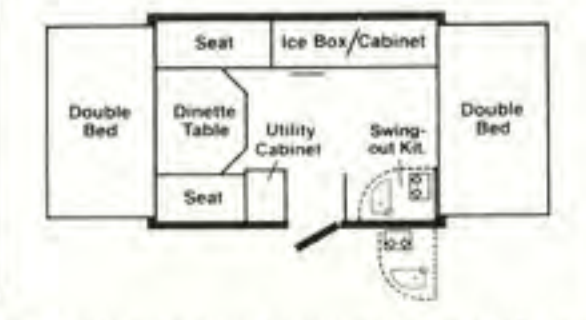

Stardust 8

- Exterior Closed:**
 Length (Overall) 14'4"
 (Minus Hitch & Bumper) 10'
 Width 6'11"/Height 4'8"
- Interior Erected:**
 Length 19'/Width 6'4"
 Height 6'5"
- Bunk Sizes:**
 Extended Ends 54" x 72"
 Dinette 40" x 76"
 Gaucho 40" x 76"
- Tire Size:**
 6:50 x 13"/Load Range C
- Tire Rating:**
 1340 lbs. at 60 psi
- Coupler Size: 2"**
- *Curb Weight:**
 Trailer 1475 lbs.
 Hitch 190 lbs.
- *GVWR:**
 Trailer 2680 lbs.
 Hitch 300 lbs.
- **Rated Cargo Load: 1205 lbs.**

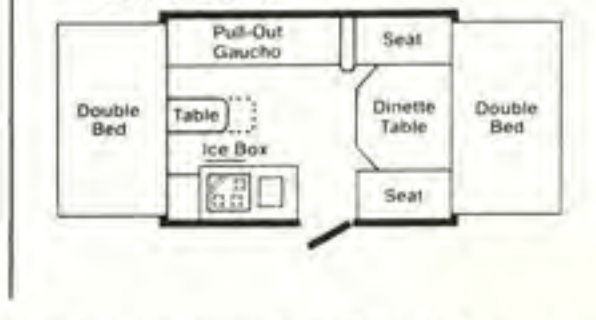

*Curb Weight is the standard unit with no options (all systems dry).

*Gross Vehicle Weight Rating is maximum total weight permissible and requires the minimum hitch weight listed above.

ON IN 11 DIFFERENT STARCRAFT CAMPER



Starmaster 8

Exterior Closed:
 Length (Overall) 14'4"
 (Minus Hitch & Bumper) 10'
 Width 6'11"/Height 4'6"

Interior Erected:
 Length 19'/Width 6'4"
 Height 6'5"

Bunk Sizes:
 Extended Ends 54" x 72"
 Dinette 40" x 76"

Tire Size:
 5:30 x 12"/Load Range C

Tire Rating:
 1045 lbs. at 80 psi

Coupler Size: 2"

***Curb Weight:**
 Trailer 1410 lbs.
 Hitch 190 lbs.

***GVWR:**
 Trailer 2090 lbs.
 Hitch 300 lbs.

****Rated Cargo Load: 680 lbs.**

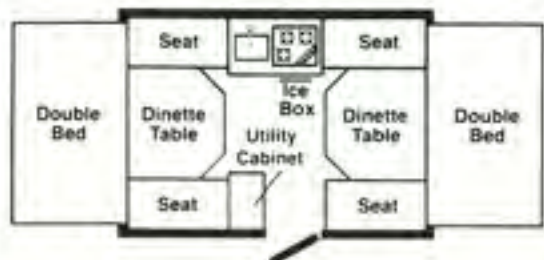

Starmaster 6

Exterior Closed:
 Length (Overall) 14'4"
 (Minus Hitch & Bumper) 10'
 Width 6'11"/Height 4'6"

Interior Erected:
 Length 19'/Width 6'4"
 Height 6'5"

Bunk Sizes:
 Extended Ends 54" x 72"
 Dinette 40" x 76"

Tire Size:
 5:30 x 12"/Load Range C

Tire Rating:
 1045 lbs. at 80 psi

Coupler Size: 2"

***Curb Weight:**
 Trailer 1480 lbs.
 Hitch 180 lbs.

***GVWR:**
 Trailer 2090 lbs.
 Hitch 300 lbs.

****Rated Cargo Load: 660 lbs.**

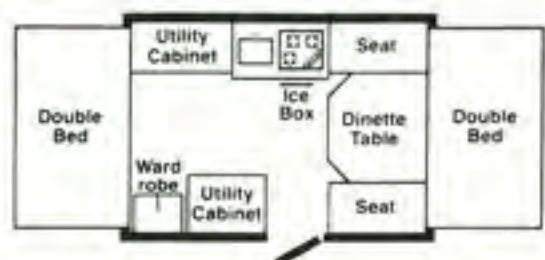

Starflite 6

Exterior Closed:
 Length (Overall) 12'4"
 (Minus Hitch & Bumper) 8'
 Width 6'11"/Height 4'6"

Interior Erected:
 Length 16'/Width 6'4"
 Height 6'5"

Bunk Sizes:
 Extended Ends 48" x 72"
 Dinette 40" x 76"

Tire Size:
 5:30 x 12"/Load Range C

Tire Rating:
 1045 lbs. at 80 psi

Coupler Size: 2"

***Curb Weight:**
 Trailer 1235 lbs.
 Hitch 195 lbs.

***GVWR:**
 Trailer 2000 lbs.
 Hitch 250 lbs.

****Rated Cargo Load: 775 lbs.**

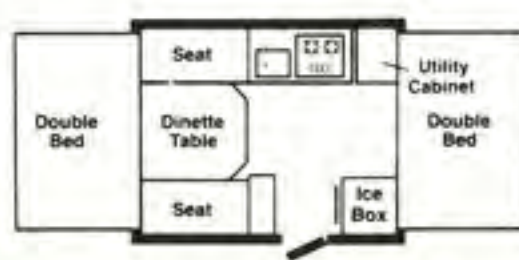

Starlite 7

Exterior Closed:
 Length (Overall) 12'4"
 (Minus Hitch & Bumper) 8'
 Width 6'11"/Height 4'6"

Interior Erected:
 Length 16'/Width 6'4"
 Height 6'5"

Bunk Sizes:
 Extended Ends 48" x 72"
 Dinette 40" x 76"
 Gaucho 20" x 76"

Tire Size:
 5:30 x 12"/Load Range C

Tire Rating:
 1045 lbs. at 80 psi

Coupler Size: 2"

***Curb Weight:**
 Trailer 1035 lbs.
 Hitch 130 lbs.

***GVWR:**
 Trailer 2000 lbs.
 Hitch 250 lbs.

****Rated Cargo Load: 965 lbs.**

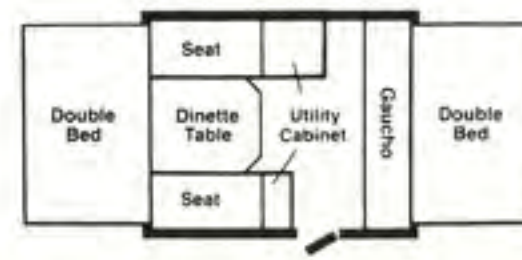

Starlette XL

Exterior Closed:
 Length (Overall) 11'5 1/2"
 (Minus Hitch & Bumper) 7'
 Width 6'3 3/4"/Height 3'5 1/2"

Interior Erected:
 Length 7'2"/Width 13'6 1/2"
 Height 6'3"

Bunk Sizes:
 Extended Ends 48" x 75"
 Dinette 40" x 67 1/2"

Tire Size:
 5:70 x 8"/Load Range B

Tire Rating:
 715 lbs. at 50 psi

Coupler Size: 2"

***Curb Weight:**
 Trailer 975 lbs.
 Hitch 105 lbs.

***GVWR:**
 Trailer 1430 lbs.
 Hitch 200 lbs.

****Rated Cargo Load: 455 lbs.**

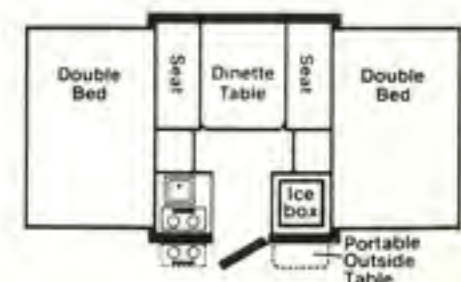

****Rated Cargo Load is with systems dry and no options installed. We recommend normal loads 100 to 300 lbs. below full GVWR. Actual weight of any Starcraft camper will vary based on the specific options installed.**

TRAILERS CAMPER



Starlette[†]

Exterior Closed:

Length (Overall) 11'5 1/2"
(Minus Hitch & Bumper) 7'
Width 6'3 3/4"/Height 3'5 1/2"

Interior Erected:

Length 7'2"/Width 13'6 1/2"
Height 6'3"

Bunk Sizes:

Extended Ends 48" x 75"
Dinette 40" x 67 1/2"

Tire Size:

5:70 x 8"/Load Range B

Tire Rating:

715 lbs. at 50 psi

Coupler Size: 2"

Curb Weight:

Trailer 850 lbs.
Hitch 100 lbs.

GVWR:

Trailer 1430 lbs.
Hitch 200 lbs.

*Rated Cargo Load: 580 lbs.

Shown with opt. Appearance/
Convenience Group.

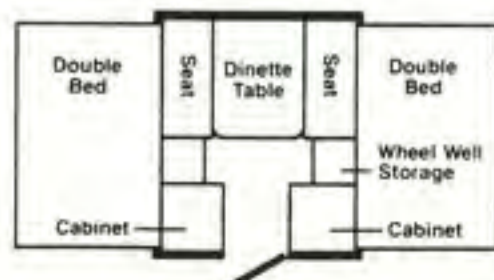

STANDARDS	Galaxy 6	Galaxy 8	Galaxy Swinger	Stardust	Stardus Swinger	Starmast	Starmast	Starflite	Starlite 7	Starlette	Starlette
Dinette Table(s)	1	1	2	1	1	1	2	1	1	1	1
Additional 1/2 Dinette		X		X							
Outside Utility Table			X							X	X
Wardrobe (W) Clothes Rack (R)	W	W	R	R	R	W	R	R	R		
Adjustable Kitchen (Swinger—SW)	X	X	SW	X	SW	X	X	X			X
2-Burner Gas Stove—Brushed Chrome			X		X			X			X
3-Burner Gas Stove—Brushed Chrome	X	X		X		X	X				
Fiberglass Icebox (Cu. Ft.)	4	4	4	2.5	4	2.5	2.5	2.5			1.5
Stainless Steel Sink	X	X		X							X
Color-Coordinated Sink			X		X	X	X	X			
Sink Covers	X	X	X	X	X	X	X	X			X
Water Tank w/Galley Pump (Gal.)	10	10	10	10	10	10	10	10			7
City Water Connection	X	X	X	X	X	X	X	X			X
Ceiling-Mounted Light(s)	2	2	2	2	2	1	1	1			1
3-Way Windows: Screen/Vinyl/Canvas						X	X	X	X	X	
Screen/Vinyl/Decorator Curtains	X	X	X	X	X						X
2-Way Bunk Windows	X	X	X	X	X	X	X	X	X	X	X
Side Storage Trunk	X	X	X		X						
Pole Storage Compartment	X	X	X	X	X	X	X				
110/12-Volt Converter System (Amps)	3	3	3	3	3	1.5					1.5
25-Ft. 110-Volt Power Cord	X	X	X	X	X	X	X	X			X
Duplex Outside Receptacle	X	X	X	X	X	X	X				
One-Piece Vinyl Bunk End Roofs	X	X	X	X	X	X	X	X	X		
Striped Canvas Bunk Roofs										X	X
Sectionalized Canvas Sides	X	X	X	X	X	X	X	X	X		
Roof Vent	X	X	X	X	X	X	X	X			X
Two Stabilizing Jacks (Rear Only)				X		X	X	X	X		
Four Stabilizing Jacks	X	X	X		X					X	X
Chrome Hubcaps	X	X	X	X	X	X	X	X	X		X
Crank-Up Lifter w/Safety Catch	X	X	X	X	X	X	X	X	X	X	X
10-In. Hydraulic Surge Brakes	X	X	X								
Frame-Mounted Bumper	X	X	X	X	X	X	X	X			X
L.P. Bottle, Holder & Regulator	X	X	X	X	X	X	X	X			X
Doorstep	X	X	X	X	X						X
Fire Extinguisher	X	X	X	X	X	X	X	X			X
OPTIONS											
Doorstep						X	X	X	X		
Appearance & Convenience Group*										X	
Canopy**	X	X	X	X	X	X	X	X	X	X	X
Add-A-Room ^{††††}	X	X	X	X	X	X	X	X	X	X	X
Screen Enclosures ^{**††}	X	X	X	X	X	X	X	X	X	X	X
9,000/10,000 BTU Heater	X	X	X	X	X	X	X	X			
7-In. Hydraulic Surge Brakes						X	X	X	X		
10-In. Hydraulic Surge Brakes				X	X						
7 1/4-In. Electric Brakes										X	X
2.5 Cu. Ft. Electric Refrigerator	X	X	X	X	X	X	X				
Boat Rack	X	X	X	X	X	X	X	X	X		
Spare Tire & Wheel	X	X	X	X	X	X	X	X	X	X	X
Spare Tire Cover	X	X	X	X	X	X	X	X	X	X	X
Single L.P. Gas Bottle Cover	X	X	X	X	X	X	X	X			X
Double L.P. Gas Bottle Cover	X	X	X	X	X	X	X	X			
Privacy Curtains	X	X	X	X	X	X	X	X	X	X	X

*Includes striped canvas, chrome hubcaps, dinette back cushions with supports, dinette window, and rear bumper with step.

**6, 8, 10, 12 feet depending on unit box size.

†Heater not available with optional Add-A-Room. ††Canopy required.

OPTIONS

1. Spare tire, wheel, bracket and cover.
2. Add-A-Room.
3. 2.5-cubic-foot electric refrigerator.
4. Hydraulic surge brakes.
5. Door step (standard on Galaxy and Stardust).
6. Hitch-mounting spare tire, wheel, bracket and cover (Starlette only).
7. L.P. gas bottle cover.
8. Privacy curtains.
9. 9/10,000-BTU fresh air vented heater.
10. Top-mounting boat rack.
11. Canopy.
12. Screen enclosures.



STARCRAFT CAMPER CLUB



Owning a Starcraft camper gives you and your family the opportunity to join the Starcraft Camper Club. Members from all over the United States and Canada share the good times through organized camping activities. There are local weekend outings and monthly Rallies. An International Rally is held each year.

And there's more. As a member of the Club you'll meet a lot of people who share your interests. You'll receive the Club's quarterly magazine, *Chatter*. A membership plaque with your exclusive number to attach to your unit. And the opportunity to purchase distinctive Starcraft Camper Club merchandise from our catalog.

Ask your dealer for more information. Or write to the Camper Club director at Starcraft Company, 2703 College Avenue, Goshen, Indiana 46526.

1. Huge 200'x40' circus tent, where over 2000 campers enjoyed a Pig Roast.
2. The tug-of-war was great fun.
3. The Minnesota Chapter supplied the crew to cook nine whole pigs.
4. Over 400 Starcraft vehicles came.

All product illustrations and specifications are based on information available at the time of publication. Some of the equipment shown separately and on product illustrations is optional at extra cost.

Starcraft reserves the right to make changes without notice or obligation. Your local Starcraft dealer will have exact specifications and product offerings.

The laws of your state may require that your Starcraft camping trailer have brakes. Determine the need for brakes by adding the weight of options you plan to purchase to the curb weight of the model you have chosen. These weights are available from your dealer. Compare your camper weight, plus your anticipated cargo load needs to the weight laws in your state of residence. If your trailer weight exceeds the legal limit, brakes should be added to your order.

You should familiarize yourself with the laws of states within which you plan to travel.

The Recreation Vehicle Industry Association has established standards for the plumbing, electricity and L.P. gas systems

for camping trailers. For your safety, all 1977 Starcraft camping trailers meet or exceed those standards. This is exemplified by the R.V.I.A. seal our units carry.

Starcraft camping trailers are built to conform to or exceed the codes and standards established by the Recreation Vehicle Industry Association and applicable local codes. Because local codes and standards sometimes require alterations in equipment, systems and/or components and because local codes are subject to change, differences in standard equipment and/or specifications for coded models are not necessarily reflected in this catalog. You are therefore advised to consult your Starcraft dealer concerning differences in coded models in areas where local codes are applicable.



STARCRAFT

A Bangor Punta Company

YOUR STARCRAFT DEALER