

Flagstaff

MAC, CLASSIC, HIGH WALL &
HARD SIDE TENT CAMPERS



MAC, CLASSIC, HIGH WALL &
HARD SIDE TENT CAMPERS

Flagstaff

FLAGSTAFF

MAC / LTD SERIES



MAKING YOUR INVESTMENT GO A LONG WAY

Flagstaff takes pride in packing the most value possible into our MAC/LTD series. While coming standard with many features, you still have flexibility to incorporate as many options as you choose to fit your camping preferences.



206ST

FLAGSTAFF STANDARD & OPTIONAL FEATURES

MAC / LTD SERIES

Here are a few features that make our tent campers meet and exceed expectations.



Water Pump w/ Filter
(Std.)



Easy glide scissorpole bed supports
(Except LTDs)



Plywood Bed Ends
(N/A Hard Side)

Heated Mattress
(Std. Opt.)

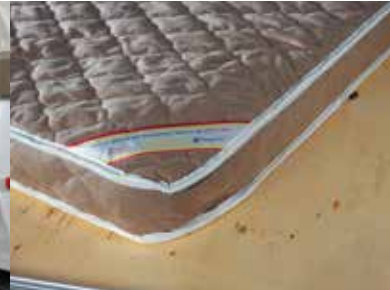

Outside grill
(Std. MAC/LTD, Classic, Hard Side, High Wall Opt. LTD)



Under floor 20 gallon water tank
(Except LTDs)



Crank Down stabilizer Jack *(Std.)*



Swing down galley *(Except LTDs)*

FLAGSTAFF

CLASSIC SERIES



ITS TIME TESTED PROVEN PERFORMANCE MAKES THIS A CLASSIC.

Year in and year out the Classic series consistently delivers with outstanding features and styling to enhance your camping experience. The swing down galley and standard power lift make the classic a breeze to set up. The expansive seating throughout the camper gives everyone plenty of room to sit and enjoy themselves.



625D

FLAGSTAFF STANDARD & OPTIONAL FEATURES

CLASSIC SERIES

These are a few of the features offered to bring comfort and convenience to your day.



Hanging Shirt Bar
(Std. Classic & High Wall)

Bunk Light and Fan
(Std. Classic & High Wall)

Water Filter
(Std. with Hot Water Heater)

Heated Mattress
(Std. Opt.)



Sliding Storage Trunk
(Some Models)

Fantastic Fan *(Except LTDs.)*

Outside Shower
(Incl. w/ Hot Water Pkg: Std: Classic, Hard Side, High Wall and Opt: MAC/LTD)

Large Entry Assist Handle
(Except LTD's)

FLAGSTAFF

HIGH WALL SERIES



AFTER ALL, IT'S YOUR VACATION THEN WHY NOT GO IN STYLE?

The Flagstaff High Wall campers are perfect for those families who want the luxurious features of a travel trailer in a much lighter towable option. The Cherry colored cabinetry, stainless steel finishes and beautiful tile-look flooring puts this camper in a class of its own.



HW27KS

FLAGSTAFF STANDARD & OPTIONAL FEATURES

HIGH WALL SERIES



AM/FM Stereo with CD Player
(Std. Classic, Hard Side & High Wall)

Double Entry Step (Std. MAC BR Models and All HW Models)

Power Lift (Std. Classic, High Wall and MAC BR models. Opt. MAC/LTD)



Beautiful hardwall shower with a residential-style flush toilet complete with a 12-gallon black water holding tank. (Std. High Wall Except HW25FS)

Black water hose storage
(Std. HW models Except HW25FS)

Hanging Wardrobe
(Opt. all Models Except MAC, Hard Side & LTD's)



Add-a-Room with Privacy Panels
(Opt. all Models Except Hard Side)



FLAGSTAFF TENT CAMPER

QUALITY CONSTRUCTION



- 1) Three Stage Double Arm Lifter Posts (NA Hard Side)
- 2) Fiberglass Vacuum Bonded Radius Roof w/ No Center Seam (NA Hard Side)
- 3) Five-Piece Vinolon Supreme Tenting (NA Hard Side)
- 4) E-Z Crank Down Stabilizer Jacks w/Sand Pads
- 5) Full Perimeter Aluminum Bed Frames (NA Hard Side)
- 6) Plywood Bunk Ends (NA Hard Side)
- 7) Seven-Way Pigtail Wiring
- 8) Under Floor 20 Gallon Fresh Water Tank (LTDs 11 Gallon Above Floor)
- 9) Powder Coated Tubular Steel Frame
- 10) Powder Coated Rafter Poles and Bed Bows (NA Hard Side)
- 11) Air Conditioner Reinforcing Laminated Into Roof (NA Hard Side)
- 12) Steel Belted Radial Tires
- 13) Easy Lube Axles (Except LTDs)
- 14) Smooth Fiberglass Vacuum Bonded Exterior (NA on MAC/LTDs)
- 15) One-Piece Door (Except LTDs & Hard Side)

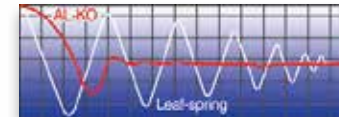

The UltraLube™ Hubs allow you to repack bearings quickly and easily without disassembly.

AL-KO® AXLES AND EASY LUBE HUBS

AL-KO Axles offer many advantages over conventional axles:

- Fully Independent Wheel Suspension
- No Metal to Metal Contact and No Springs, Shackles, Hangers, or U-bolts to Break or Wear Out
- Lower Trailer Center of Gravity For Improved Stability

Note: Torsion Axles on Classics, HS's and HW's only. Easy-Lube Hubs on all units except LTDs.

FLAGSTAFF

HARD SIDE SERIES



WHAT STORES AWAY LIKE A TENT CAMPER AND PERFORMS LIKE A TRAVEL TRAILER?

The Hard Side tent camper brings a smooth, fiberglass vacuum bonded exterior with quick, easy set up, while retaining the towing and storage advantages of the Classic tent camper. Making it the perfect product for your camping adventure.



T12RBST



Hard Side Awning & Screen Room option.

FLAGSTAFF FLOORPLANS

HARD SIDE SERIES



T12RB

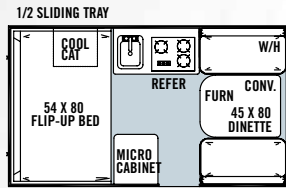

1/2 SLIDING TRAY
RVQUE GAS GRILL

T12RBST

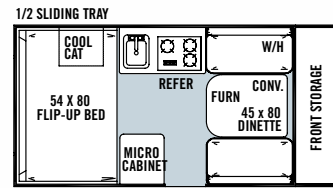

1/2 SLIDING TRAY
RVQUE GAS GRILL

T12SCST

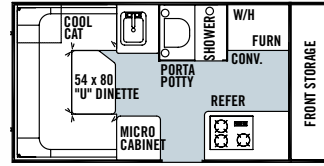

RVQUE GAS GRILL

T12DDST

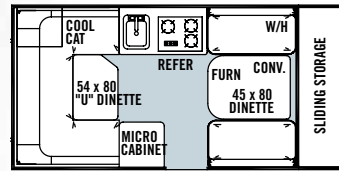

RVQUE GAS GRILL

T12BH

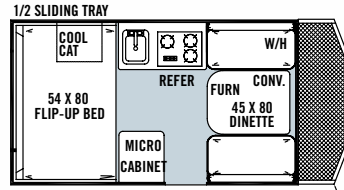

1/2 SLIDING TRAY
RVQUE GAS GRILL
28 x 84 FRONT DECK STORAGE
W/ EXPANDED METAL DECKING

T12RBTH

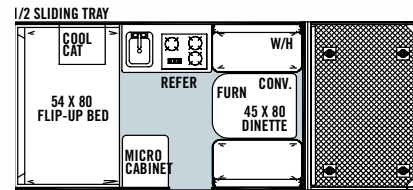

1/2 SLIDING TRAY
RVQUE GAS GRILL
57 x 84 FRONT DECK STORAGE
W/ EXPANDED METAL DECKING

T12SDTH

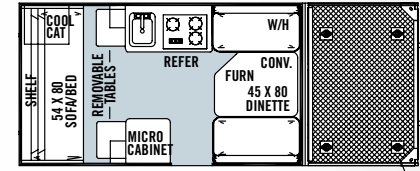

RVQUE GAS GRILL
57 x 84 FRONT DECK STORAGE
W/ EXPANDED METAL DECKING

T19SCHW

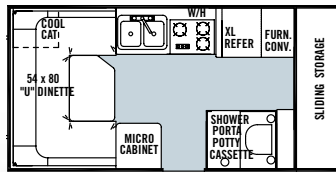

RVQUE GAS GRILL



Specifications

Model number of any particular unit does not necessarily reflect the overall length of the unit itself. Dry weight are estimates.

MODEL	T12RB	T12RBST	T12SCST	T12DDST	T12BH	T12RBTH	T12SDTH	T19SCHW
BASE/DRY UNIT WEIGHT	1888	1955	1949	1916	1973	2186	2152	2052
BASE DRY HITCH WEIGHT	261	283	280	262	292	354	349	327
BASE DRY AXLE WEIGHT	1627	1672	1669	1654	1681	1832	1803	1725
CARGO CAPACITY	1017	1217	1217	1217	1217	1630	1678	1237
BOX SIZE	12'	12'	12'	12'	12'	12'	12'	12'
TRAILER SIZE (CLOSED W/ HITCH)	17' 1"	18' 11"	18' 11"	18' 11"	19' 2"	22' 1"	22' 1"	18' 11"
HEIGHT (CLOSED)	60"	60"	60"	60"	60"	65"	65"	64"
FRESH WATER CAPACITY	26	26	26	26	26	26	26	26

FLAGSTAFF FLOORPLANS

CLASSIC SERIES

Specifications

Model number of any particular unit does not necessarily reflect the overall length of the unit itself.
Dry weight are estimates.

MODEL	620ST	720BH	823D	425D	625D
BASE/DRY UNIT WEIGHT	1986	2018	2445	2446	2473
BASE DRY HITCH WEIGHT	258	299	358	303	292
BASE DRY AXLE WEIGHT	1728	1713	2087	2143	2181
CARGO CAPACITY	1017	1262	894	838	800
BOX SIZE	10' 0"	10' 0"	12' 0"	12' 0"	12' 0"
TRAILER SIZE (Closed w/ Hitch)	17' 1"	17' 3"	19' 1"	19' 1"	19' 1"
HEIGHT (Closed)	57"	57"	61"	61"	61"
TRAILER LENGTH (Open)	20' 4"	20' 6"	23' 9"	23' 9"	23' 9"
FRESH WATER CAPACITY	26	26	26	26	26

620ST

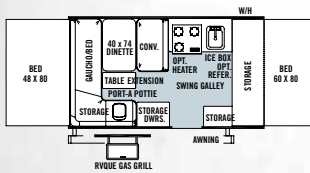

720BH

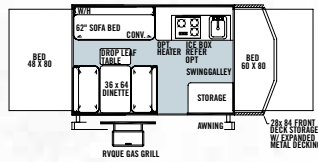

823D

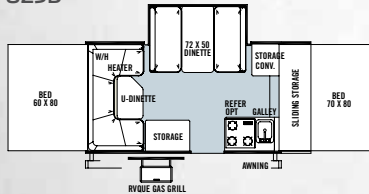

425D

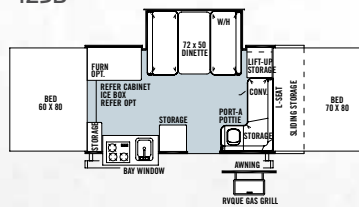

625D

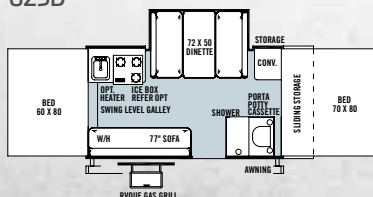

FLAGSTAFF FLOORPLANS

HIGH WALL SERIES

Specifications

Model number of any particular unit does not necessarily reflect the overall length of the unit itself.
Dry weight are estimates.

MODEL	HW 25FS	HW 27SC	HW 27KS	HW 29SC	HW 31SCTH
BASE/DRY UNIT WEIGHT	2773	2806	2959	3135	3676
BASE DRY HITCH WEIGHT	315	279	359	373	404
BASE DRY AXLE WEIGHT	2458	2527	2600	2762	3272
CARGO CAPACITY	1042	935	862	1217	2317
BOX SIZE	12'	14'	14'	16'	14'
TRAILER SIZE (Closed w/ Hitch)	19' 1"	19' 4"	19' 4"	21' 4"	28' 4"
HEIGHT (Closed)	71"	71"	71"	72"	71"
TRAILER LENGTH (Open)	23' 9"	25' 9"	25' 9"	27' 9"	33' 9"
FRESH WATER CAPACITY	26	26	26	26	26
GRAY WATER CAPACITY	6	12	12	12	12
BLACK WATER CAPACITY	N/A	12	12	12	12

HW25FS

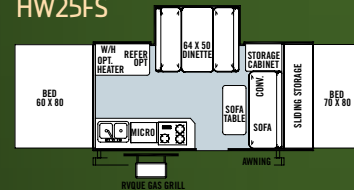

HW27SC

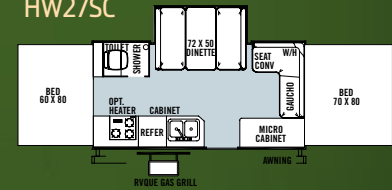

HW27KS

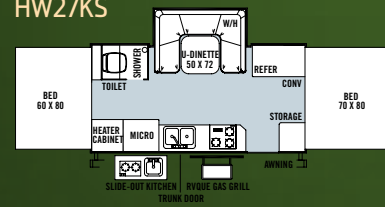

HW29SC

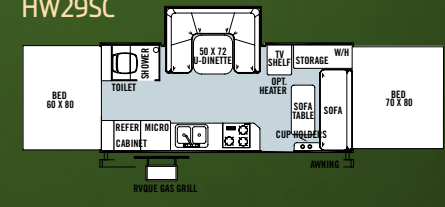

HW31SCTH

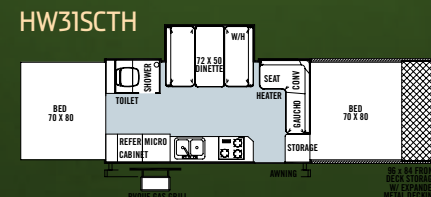

206ST

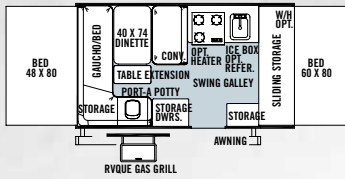

205

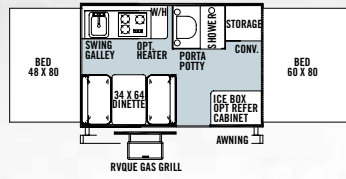

207

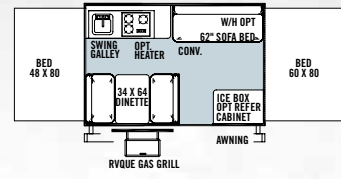

208

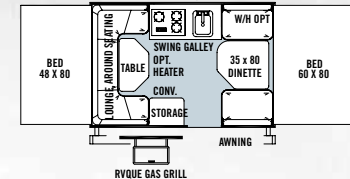

227

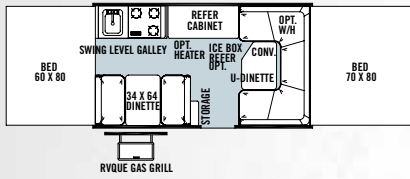

228

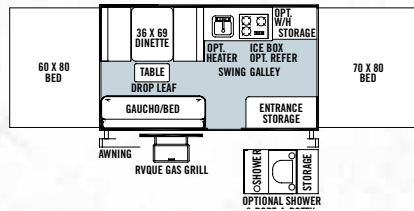

228BH

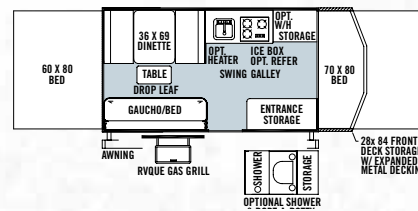

228D

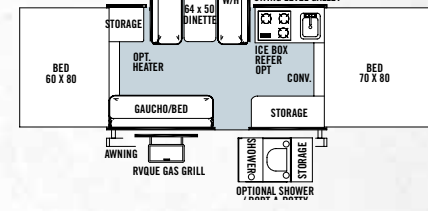

246D

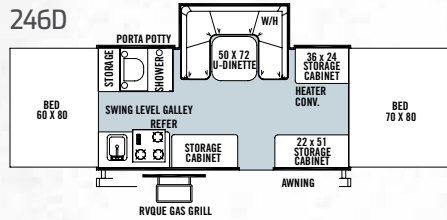

BR23SC

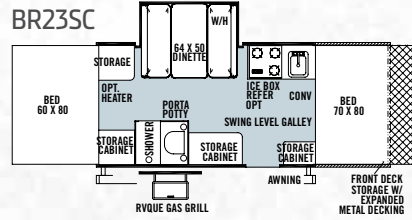

BR28TSC

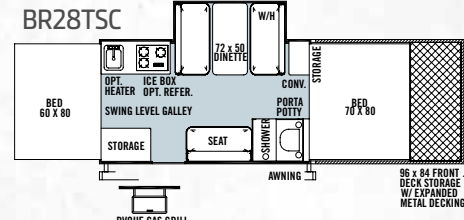

176LTD

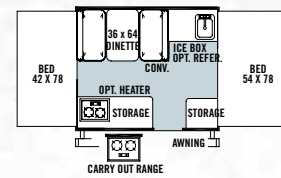

206LTD

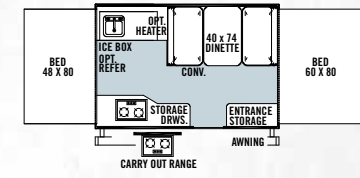

FLAGSTAFF FLOORPLANS

MAC / LTD SERIES

Specifications

Model number of any particular unit does not necessarily reflect the overall length of the unit itself. Dry weight are estimates.

MODEL	206ST	205	207	208	227	228	228BH	228D	246D	176LTD	206LTD	BR23SC	BR28TSC
BASE/DRY UNIT WEIGHT	1867	1732	1764	1737	2006	2050	2064	2153	2364	1344	1493	2579	2975
BASE DRY HITCH WEIGHT	233	240	252	219	293	331	350	313	249	190	174	310	219
BASE DRY AXLE WEIGHT	1634	1492	1512	1518	1713	1719	1714	1840	2115	1154	1319	2269	2756
CARGO CAPACITY	1097	917	866	866	966	966	1017	891	866	683	762	1212	2317
BOX SIZE	10'	10'	10'	10'	12'	12'	12'	12'	14'	8'	10'	12'	12'
TRAILER SIZE (Closed w/ Hitch)	17' 1"	15' 3"	15' 3"	15' 3"	17' 2"	17' 2"	18' 8"	17' 2"	19' 2"	12'	14'	21' 9"	26'
HEIGHT (Closed)	57"	57"	57"	57"	57"	57"	57"	57"	57"	56"	56"	62.5"	62.5"
TRAILER LENGTH (Open)	20' 4"	20' 1"	20' 1"	20' 1"	23' 10"	23' 10"	23' 10"	23' 10"	25' 10"	17' 1"	20' 1"	26' 5"	30' 8"
FRESH WATER CAPACITY	20	26	20	20	20	20	20	20	26	11	11	26	26

FLAGSTAFF MAC, CLASSIC, HIGH WALL & HARD SIDE TENT CAMPER

STANDARDS & OPTIONS

Standards & Options are subject to change.

MODELS	LTD	M	C	HS	HW
STANDARD & OPTIONAL FEATURES					
Cherry Interior with "Tile-Look" Linoleum	--	--	S	S	S
Hickory Interior with "Tile-Look" Linoleum	S	S	--	--	--
Two-Tone Fabric Interiors	S	S	S	S	S
Residential Style Kitchen Faucet	S	S	S	S	--
Stainless Steel Look Appliances and Sink	--	--	S	S	S
Double Pan Sink with High Rise Faucet (HS: T19SCHW Only)	--	--	--	S*	S
Electric Water Pump	S	S	S	S	S
Hot Water Package (Incl. Water Filter, Outside Shower, Six Gallon DSI Hot Water Heater) (M: 206ST, 207, 208, 227, 228, 228BH, 228D)	--	0*	S	S	S
Port-a-Potty (M: 206ST Only C: 620ST, 425D HS: T12RB, T12RBST, T12BH, T12DDST, T12RBTH, T12SDTH)	--	S*	S*	S*	--
Shower Cassette Package Incl. Water Filtration System, Six Gallon DSI Hot Water Heater, Demand Water Pump, and Cassette Toilet (Opt. M: 228, 228BH, 228D) (Std. L: 205, 246D, BR23SC, BR28TSC C: 625D, HS: T12SCST)	--	S*/0*	S*	S*	--
Hard Wall Shower with Residential Flush Toilet (N/A HW25FS)	--	--	--	--	S*
Fold Over Galley with Upper and Lower Storage (Std. C: 425D Only)	S	--	S*	--	--
Two Burner Free-Standing Range	S	--	--	--	--
Swing Level Galley with Storage (N/A C: 425D, 823D)	--	S	S*	--	--
Permanently Mounted 3-Burner Indoor Range w/ Stove Cover	--	S	S	S	--

MODELS	LTD	M	C	HS	HW
Three Burner Stove with Oven (HS: T19SCHW Only)	--	--	--	S*	S
Microwave	--	--	--	S	S
Large Built-In Icebox	S	S	S	--	--
1.9 Cubic Ft. Refrigerator	0	0	--	--	--
3 Way Refer 2.5 cu. ft. 110V & 12V	--	--	0	S	--
Extra Large 4.0 cu. ft. Refrigerator (HS: T19SCHW Only)	--	--	--	S*	0
Free Standing Lite-Ply Table --					
High Pressure Laminate	S	S	S	S	S
Comfortable Family Style Dinette w/ 4" Cushions	S	S	S	S	S
Residential Style Raised Panel Doors	--	--	S	S	S
Wood Drawers w/ Full Extension Metal Guides	S	S	S	S	S
Large Clothes Bar	--	--	S	S	S
Hanging Wardrobe	--	--	0	--	0
Hanging Pantry	--	0	0	--	0
AM/FM Stereo with CD player	--	--	S	S	S
TV Outlet with Cable and Satellite Hook Up	--	S	S	S	S
LCD TV (HW29SC Only)	--	--	--	--	S*
30 Amp Detachable Power Cord w/ Storage Bag	--	S	S	S	S
25 Amp Converter w/ Built in Battery Charger	S	--	--	--	--
35 Amp Converter w/ Built in Battery Charger	--	S	S	S	S
12V Safety Switch	S	S	S	S	S
Roof Vent	S	--	--	--	--
Create-A Breeze Three Speed Fantastic Fan	--	SO	SO	SO	SO
Air Conditioner Wiring Kit	0	0	0	--	0
10k BTU Cool Cat Heat Pump	--	--	--	S	--
13.5k BTU Air Conditioner	--	--	--	--	0
20k BTU Forced Air Furnace w/ Electric Ignition	0	0	0	0	0
Interior Floor Lights	--	--	--	S	S
2 Single Ceiling Lights	S	--	--	--	--

MODELS	LTD	M	C	HS	HW
3 Single Ceiling Lights	--	S	--	--	--
2 Double Ceiling Lights	--	--	--	S	--
3 Double Ceiling Lights w/ Jacks for Accessories	--	--	S	--	S
Bunk Light with Fan	--	--	S	--	S
LP Leak Detector	S	S	S	S	S
Carbon Monoxide Detector	0	0	0	0	0
Privacy Curtains	S	CP	CP	S	CP
Lined Privacy Curtain	--	--	S	S	S
Roof Valances	--	CP	CP	--	CP
Quilted Top Bed Mattresses	S	S	--	--	--
Quilted Top Innerspring Mattresses (HS: T12RB, T12BH, T12RBST, T12RBTH Only)	--	--	S	S*	S
Thermostatically Controlled Heated Mattresses (HS: T12RB, T12BH, T12RBST, T12RBTH Only)	0	0	0	S*	0
Leaf-Spring Axle	S	S	--	--	--
Independent Torsion Axles	--	--	S	S	S
Easy Lube Axles	--	S	S	S	S
Spare Tire, Cover and Mount	S	TP	TP	S	TP
12" Radial Tires	S	--	--	--	--
13" Radial Tires (M: Except BR Models)	--	S*	--	--	--
13" Radial Tires with Aluminum Wheels	--	--	S	S	--
14" Radial Tires with Aluminum Wheels	--	--	--	--	S
15" Mud Rover Radial Tires, Aluminum Wheels & Shocks (Std. M: BR23SC, BR28TSC Only)	--	S*	--	--	--
Electric Brakes	0	S	S	S	S
Sliding Storage Tray on All Front Trunk Models (C: Except 620ST, HS: T19SCHW Only)	--	S*	S*	S*	S*
28.5" Front Storage Deck w/ Removable Deck Railing (Std. M: 228BH, C: 720BH, HS: T12BH Only)	--	S*	S*	S*	--

LTD = LIMITED
M = MAC
C = CLASSIC

HS = HARD SIDE
HW = HIGH WALL

S = STANDARD
SO = STANDARD OPTION
O = OPTIONAL

-- NOT AVAILABLE
TP OR CP = OPTION PACKS
* = SELECTED MODELS



MODELS	LTD	M	C	HS	HW
54" Front Storage Deck (Std. C: BR23SC)	--	S*	--	--	--
57" Front Deck Storage (Std. HS: T12RBTH, T12SDTH)	--	--	--	S*	--
105" Front Storage Deck (Std. M: BR28TSC, HW: HW31SCTH Only)	--	S*	--	--	S*
(4) Bike Rack (N/A M: BR23SC BR28TSC HS: T12RBTH, T12SDTH HW: HW31SCTH)					
(Note: HS: T12RB - 2 Bikes only)	0	0*	0	0*	0*
Power Lift System (Std. M: BR23SC, BR28TSC)	0	0	S	--	S
Built-in A-Frame Mounting Provision for Equalizer					
Hitch Bar Installation	S	S	S	S	S
Battery Box and Wiring Kit	0	S	S	S	S
20 lb. LP Bottle	S	S	S	--	--
(2) 20 lb. LP Bottles (Std. M: BR23SC, BR28TSC Only)	--	S*	--	--	--
Dual 20 lb. LP Bottles with Cover	--	0	0	S	S
Automatic LP Regulator	--	0	0	S	S
Diamond Plated Front Cap	--	--	--	S	S
Diamond Plated Front, Rear and Side Skirt (M: BR23SC, BR28TSC Only)	--	S*	--	--	--
Awning	S	S	S	--	S
Awning/Screen Room	--	--	--	0	--
Screen Room w/ Privacy Panels	0	0	0	--	0
Outdoor Gas Grill w/ Worktable	0	S	S	S	S
Outside Speaker	--	--	S	S	S
Patio Light (LTD: 206LTD Only)	S*	CP	CP	S	CP
Courtesy Light on Front (M: 228BH, BR23SC, BR28TSC C: 720BH HS: All Models)	--	S*	S*	S	--
110V Exterior Outlet (LTD: 206LTD only)	S*	CP	CP	S	CP
Black Water Hose Storage (HW: N/A HW25FS)	--	--	--	--	S*

MODELS	LTD	M	C	HS	HW
Installed Door Step		S	TP*	TP	S --
Installed Double Door Step (M: BR23SC, BR28TSC Only, HW: All Models)	--	TP*	--	--	TP
One Piece Screen Door	--	S	S	--	S
Vented Entrance Door Window w/ Screen	--	--	--	S	--
Folding Grab Handle	--	S	S	S	S
Exterior Graphic Design	S	S	S	S	S
Travel Pack (Incl. Spare Tire, Tire Bracket, Tire Cover, Installed Step)	--	0	0	--	0
Convenience Pack (Incl. Privacy Curtains, Roof Valances, A/C Bracing, Patio Light, 110V Exterior Outlet)	--	0	0	--	0

STANDARD CONSTRUCTION FEATURES

Completely Enclosed Living Area	--	--	--	S	--
Fiberglass Vacuum Bonded Roof with Metal Interior Roof	--	--	--	S	--
Large Rear Roof Tinted Sky Light with Shade	--	--	--	S	--
Two Front Roof Tinted Windows with Shades	--	--	--	S	--
Fiberglass Vacuum Bonded Radius Roof w/ No Center Seam	S	S	S	--	S
Steel Air Conditioner Vent Reinforcing Laminated Into Roof	S	CP	CP	--	CP
CP 3-Stage Double Arm Lifter Posts	S	S	S	--	S
Smooth Fiberglass Vacuum Bonded Exterior w/ Black Accents	--	--	S	--	S
Smooth Fiberglass Vacuum Bonded Exterior	--	--	--	S	--
Lower Door Operational in Closed Position	S	S	S	--	S
Five Piece Sectionalized Vinolon Supreme Tenting	S	S	S	--	S
Tent Permanently Attached on Bunk Ends					

MODELS	LTD	M	C	HS	HW
and Slide Out	S	S	S	--	S
Plywood Bunk Ends	S	S	S	--	S
Full Perimeter Aluminum Bed Frames	S	S	S	--	S
Easy Glide Scissor Pole Bed Supports	--	S	S	--	S
Powder Coated Rafter Poles and Bed Bows	S	S	S	--	S
Tinted Vinyl Windows	S	S	S	--	S
Large, Opening Picture Window	--	--	--	S	--
One Piece Undercoated Structure wood Floor	S	S	S	S	S
Powder Coated Tubular Steel Frame	S	S	S	S	S
Rear Crank Down Stabilizer Jacks w/ Sand Pads	S	--	--	--	--
(4) E-Z Crank-Down Stabilizer Jacks w/ Sand Pads	--	S	S	S	S
Seamless, High Density Polyethylene					
Wheel Wells	S	S	S	S	S
11 Gallon Fresh Water Tank	S	--	--	--	--
Under Floor 20 Gallon Fresh Water Tank	--	S	S	S	S
12 Gallon Gray Water Holding Tank (HW: N/A HW25FS)	--	--	--	--	S*
6 Gallon Gray Water Holding Tank (HW: HW25FS Only)	--	--	--	--	S*
12 Gallon Black Water Holding Tank (HW: N/A HW25FS)	--	--	--	--	S*
2000 lb. Tongue Jack w/ Swivel Wheel	S	S	S	S	S
Power Front Jack	--	--	--	0	0
7-Way Pigtail Plug	S	S	S	S	S

LTD = LIMITED
M = MAC
C = CLASSIC

HS = HARD SIDE
HW = HIGH WALL

S = STANDARD
SO = STANDARD OPTION
O = OPTIONAL

-- NOT AVAILABLE
TP OR CP = OPTION PACKS
* = SELECTED MODELS



PRE-DELIVERY INSPECTION FACILITY

20,000 square feet of quality assurance. The bare essentials for a premium product. This state-of-the-art facility gives immediate daily feedback to production for quality assurance in every unit built.



FLAGSTAFF

WARRANTY

For details on Flagstaff's complete warranty program, see your Flagstaff dealer. When it comes to backing products with the same quality and commitment it does when it begins the manufacturing process, the only name you have to remember when you're looking for a recreational vehicle is Flagstaff. Flagstaff offers the following additional limited warranties to the original purchasers. Consult written warranty for details.

1. Five-year roof warranty, 2. Twenty-five-year floor warranty, 3. Five-year frame warranty, 4. Five-year tent warranty, 5. Five-year warranty on torsion axle suspension, 6. Limited life-time warranty of lifter system, 7. One-year bumper to bumper. Ask your dealer about the available lifetime structural warranty.



Forest River, Inc. encourages our customers to purchase their Forest River products from a local dealership whenever possible for the following reasons:

- 1) Forest River, Inc. dealers are independently owned and operated businesses so priority service and scheduling is at their discretion and is often provided to customers that purchased their unit at that dealership.
- 2) Purchasing locally allows customers to establish meaningful relationships with a dealer, enhancing the RV experience through assistance with product questions, user tips or RV regulations for your state or country, and much more!
- 3) Canadian customers must meet requirements to bring an RV purchased out of the country to their home. These requirements may involve additional inspections and certifications, taxes and fees. Your local Canadian Dealer is a professional at meeting these requirements.
- 4) Scheduling timely warranty repairs and adjustments through a local dealership provides far greater flexibility and convenience to you, the customer!

It is the goal of Forest River, Inc. that all of our RV owners fully enjoy the RV experience and that customer satisfaction meets or exceeds their expectations!

24/7 EMERGENCY ROADSIDE ASSISTANCE

For a worry-free ownership experience

Forest River includes one

year of Coach-Net RV Technical & Roadside

Assistance with each RV purchase. Whether new to the RV lifestyle or an experienced RV enthusiast, Forest River owners have 24/7 access to technical, operational and emergency road service coverage throughout the US & Canada.

Coach-Net's fast, dependable service is just a phone call away.

Coach-Net®

RV Technical & Roadside Assistance

YOUR FLAGSTAFF DEALER

201 West Elm Millersburg, IN 46543 | www.forestriverinc.com/Flagstaff
574.642.2640



Learn More

Scan this barcode using a QR Reader on your smart phone to learn more about Forest River.



A Berkshire Hathaway company.

All specifications contained herein are based on the latest product information at time of printing. Forest River reserves the right to make changes in colors, materials, equipment and specifications at any time without notice and assumes no responsibility for any errors in this brochure. Litho. U.S.A 2012.11.07