

FLAGSTAFF
MAC, LTD, SE, HARD SIDE
& HIGH WALL TENT CAMPERS

Flagstaff

MAC, LTD, SE, HARD SIDE & HIGH WALL TENT CAMPERS

PROVIDING OUTDOOR FUN SINCE 1974.



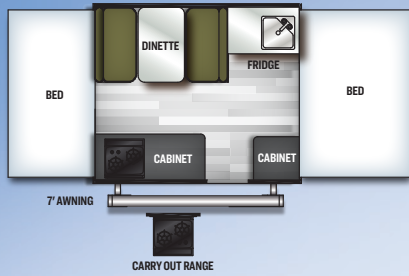

176LTD

LIMITED

FLAGSTAFF UVW: 1465 CCC: 793 AXLE: 1284 HITCH: 162

OPEN LENGTH: 17' 2" CLOSED HEIGHT: 5' 4" CLOSED LENGTH W/ HITCH: 12' 4"

BOX SIZE: 8' FRESH: 10 GRAY: N/A BLACK: N/A

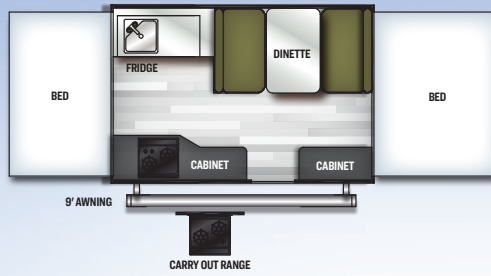

206LTD

LIMITED

FLAGSTAFF UVW: 1608 CCC: 683 AXLE: 1394 HITCH: 195

OPEN LENGTH: 20' 2" CLOSED HEIGHT: 5' 4" CLOSED LENGTH W/ HITCH: 14' 4"

BOX SIZE: 10' FRESH: 10 GRAY: N/A BLACK: N/A

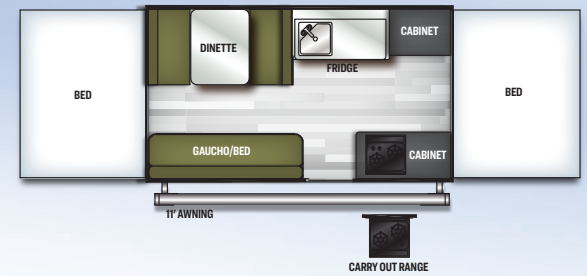

228LTD

LIMITED

FLAGSTAFF UVW: 2049 CCC: 1176 AXLE: 1805 HITCH: 225

OPEN LENGTH: 23' 1" CLOSED HEIGHT: 5' 6" CLOSED LENGTH W/ HITCH: 16' 5"

BOX SIZE: 12' FRESH: 10 GRAY: N/A BLACK: N/A

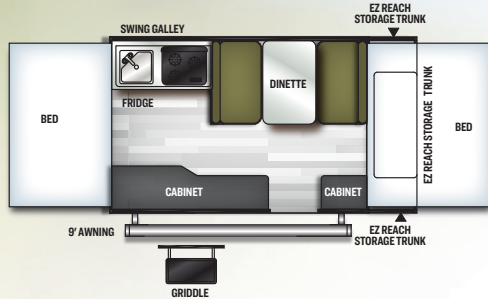

206M

MAC

FLAGSTAFF UVW: 2204 CCC: 1036 AXLE: 1945 HITCH: 240

OPEN LENGTH: 20' 2" CLOSED HEIGHT: 5' 6" CLOSED LENGTH W/ HITCH: 17' 3"

BOX SIZE: 12' FRESH: 20 GRAY: N/A BLACK: N/A

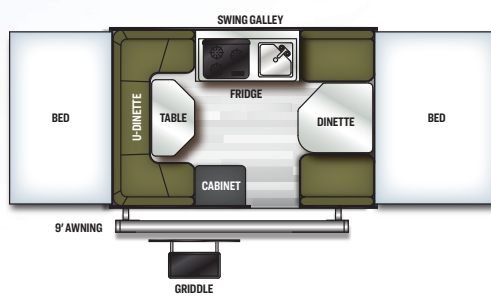

208

MAC

FLAGSTAFF UVW: 1896 CCC: 1359 AXLE: 1622 HITCH: 255

OPEN LENGTH: 20' 2" CLOSED HEIGHT: 5' 6" CLOSED LENGTH W/ HITCH: 15' 7"

BOX SIZE: 10' FRESH: 20 GRAY: N/A BLACK: N/A

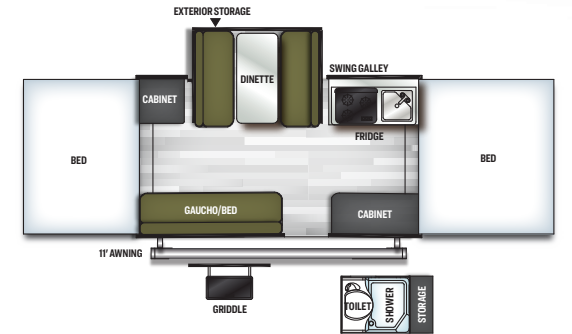

228D

MAC

FLAGSTAFF UVW: 2439 CCC: 824 AXLE: 2157 HITCH: 263

OPEN LENGTH: 23' 11" CLOSED HEIGHT: 5' 6" CLOSED LENGTH W/ HITCH: 17' 6"

BOX SIZE: 12' FRESH: 20 GRAY: N/A BLACK: N/A

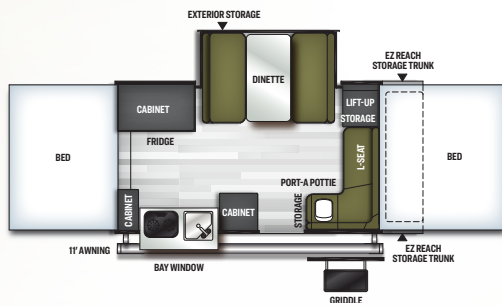

425M

MAC

FLAGSTAFF UVW: 2654 CCC: 641 AXLE: 2340 HITCH: 295

OPEN LENGTH: 23' 9" CLOSED HEIGHT: 6' CLOSED LENGTH W/ HITCH: 19' 1"

BOX SIZE: 12' FRESH: 20 GRAY: N/A BLACK: N/A

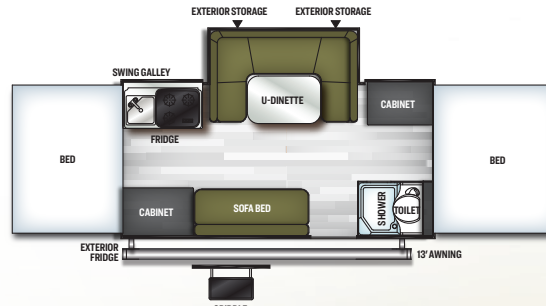

627M

MAC

FLAGSTAFF UVW: 2854 CCC: 506 AXLE: 2475 HITCH: 360

OPEN LENGTH: 25' 9" CLOSED HEIGHT: 6' CLOSED LENGTH W/ HITCH: 19' 4"

BOX SIZE: 14' FRESH: 20 GRAY: N/A BLACK: N/A

MAC

MAKING YOUR INVESTMENT GO A LONG WAY.

Flagstaff takes pride in packing the most value possible into our MAC series. Finding the perfect fit for the specific needs of your active family is made easier by the wide variety of floor plans available. While each model comes standard with many features, you still have flexibility to incorporate as many options as you choose to fit your camping preferences.

LTD PACKAGE

Battery Box & Wire
Awning
Step
Heated Mattress on Bunk Ends
CO Detector
Inside/Outside Two-Burner Stove
Spare Tire w/ Carrier & Cover
Interior LED Lights
Solar Prep On Frame
Nitrogen Filled Tires
Exterior Recep (206LTD & 228D only)

LTD STANDARD FEATURES

Gray Exterior
Slatewood Interior
Wood Look Flooring
Electric Water Pump
Antifreeze Inlet Bypass
1.9 Cubic Foot 3 Way Refrigerator

20K BTU Furnace
Residential Style Cabinet Doors
Wood Drawers w/ Full Extension
Metal Guides
One Piece Door
Flip Down Galley w/ Storage
25 AMP Converter w/ Built In Battery Charger
Roof Vent
Privacy Curtains
2 Rear Stabilizer Jacks w/ Sand Pads
Quilted Top Bed Mattress
12" Radial Tires
13" Radial Tires (228LTD Only)
20 lb. LP Bottle
Patio Light (206LTD/228LTD)
Leaf Spring Axles

LTD OPTIONS

Power Lift System (factory installed)
LP Bottle Cover
2-20# LP Bottles w/ Covers
3-Way Refrigerator (forced)
Electric Brakes (Std. 2280LTD)
20K BTU Furnace (forced)
7' Screen Room w/ Privacy Panels
9' Screen Room w/ Privacy Panels
11' Screen Room w/ Privacy Panels
Outside Griddle
40 Amp Portable Solar Panel
13500 BTU Low Profile Roof Air
15000 BTU Low Profile Roof Air

Limited

TIME TO RETIRE THE FAMILY TENT? *When it is time to retire the trusty family tent because you are tired of sleeping on the hard ground, look no further than the Flagstaff LTD Tent Camper. Light on frills but an emphasis on quality and construction. The LTD is our entry-level line of tent campers that come with a limited lifetime warranty on the lift system and a 5 year tent warranty. Oh, and don't forget the standard heated mattresses that will keep you warm and comfortable on those chilly Fall nights.*



MAC OUTDOORS PACKAGE

Create-A-Breeze Roof Vent Fan
3-Way Refrigerator
20K BTU Furnace
Heated Mattress Bunk Ends
Awning w/ LED Lighting
Water Filtration System
Spare Tire w/ Carrier & Cover
ProRac Permanent Crossbars (150lb rating)
CO Detector
Outside Griddle
Power Roof Lift

MAC STANDARD FEATURES

Gray Exterior
Slatewood Interior
Wood Plank Flooring
12V Electric Water Pump
Hot Water Package (425M/627M/228D)
Shower/Cassette (STD 2716F)
Antifreeze Inlet Bypass
Permanently Mounted 3-Burner Range w/ Cover
Residential Style Cabinet Doors & Drawers w/ Metal Glides
USB Charging Ports
Roof A/C Bracing
30 AMP detachable Power Cord

35 AMP Converter w/ Built In Power Lift System
Storage Net Over Bunks
Leaf-Spring Axles
Easy Lube Axles
Electric Brake
13" Radial Tires
Aluminum Wheel
Double Battery Box & Wiring Kit
4 Stabilizer Jacks w/ Sand Pads
Solar Panel Prep On Frame
LED Ceiling Lights
Patio Light
110V Exterior Outlet
Single Entry Step
One Piece Screen Door

Large Entry Door Folding Grab Handle
85" Wide Body w/ 80" Beds
4" Cushions & Covers
TV outlet w/ Cable & Satellite
Vinolon Supreme Tenting

MAC OPTIONS

A/C Wiring Kit
LP Bottle Cover
2-20# LP Bottles w/ Cover
Overhead Kitchen Cabinet
Shower/Cassette Pack (228D)
Hot Water Pkg. w/ Outside Shower (206M/208)
9' Screen Room w/ Privacy Panels
11' Screen Room w/ Privacy Panels

13' Screen Room w/ Privacy Panels
Pro Rac Upright Bike Carrier
Pro Rac Kayak Carrier
Pro Rac Load Stops
Pro Rac Tie Downs
40 Amp Portable Solar Panel
13,500 BTU Low Profile Roof Air
15,000 BTU Low Profile Roof Air

Sports Enthusiast Package

WELCOME TO THE FLAGSTAFF SPORTS ENTHUSIAST PACKAGE (SE), a camper designed for active couples and families. Whatever the preference; mountain biking, canoeing, paddle boarding or surfing, the SE camping trailers are designed to allow you to make the most of your outdoor experience.

Built for 21st century camping. The SE package includes a AM/FM stereo with Bluetooth technology, USB auxiliary ports for streaming and recharging, LED lighting, a WIFI Ranger WIFI booster and a 100W solar panel with 1000W inverter to supply renewable energy to your batteries while camping "off the grid."

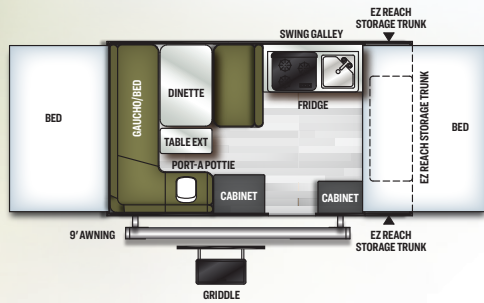

206STSE SE

FLAGSTAFF UVW: 2180 CCC: 724 AXLE: 1907 HITCH: 254
 OPEN LENGTH: 20' 4" CLOSED HEIGHT: 5' 11" CLOSED LENGTH W/ HITCH: 17' 6"
 BOX SIZE: 10' FRESH: 20 GRAY: N/A BLACK: N/A

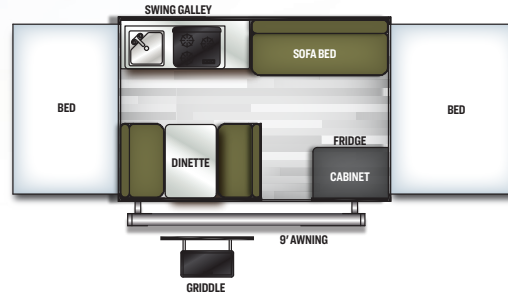

207SE SE

FLAGSTAFF UVW: 2076 CCC: 808 AXLE: 1823 HITCH: 234
 OPEN LENGTH: 20' 1" CLOSED HEIGHT: 5' 11" CLOSED LENGTH W/ HITCH: 15' 8"
 BOX SIZE: 10' FRESH: 20 GRAY: N/A BLACK: N/A

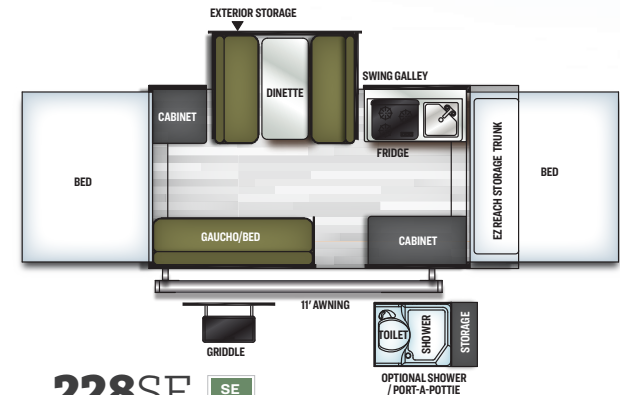

228SE SE

FLAGSTAFF UVW: 2849 CCC: 1026 AXLE: 2455 HITCH: 375
 OPEN LENGTH: 23' 11" CLOSED HEIGHT: 6' 2" CLOSED LENGTH W/ HITCH: 19' 4"
 BOX SIZE: 12' FRESH: 20 GRAY: N/A BLACK: N/A

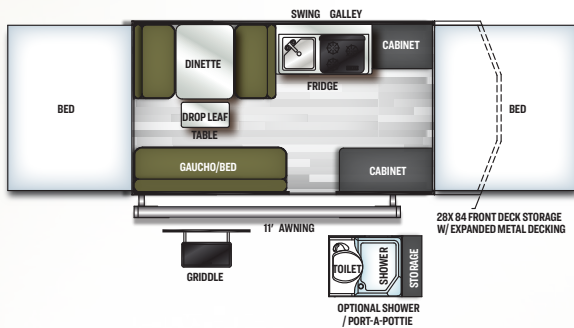

228BHSE SE

FLAGSTAFF UVW: 2559 CCC: 1279 AXLE: 2202 HITCH: 338
 OPEN LENGTH: 23' 11" CLOSED HEIGHT: 6' 2" CLOSED LENGTH W/ HITCH: 19' 4"
 BOX SIZE: 12' FRESH: 20 GRAY: N/A BLACK: N/A

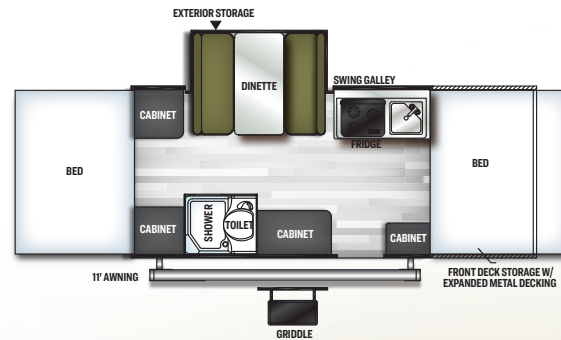

23SCSE SE

FLAGSTAFF UVW: 2933 CCC: 861 AXLE: 2620 HITCH: 294
 OPEN LENGTH: 26' 5" CLOSED HEIGHT: 6' 2" CLOSED LENGTH W/ HITCH: 22' 3"
 BOX SIZE: 12' FRESH: 20 GRAY: N/A BLACK: N/A

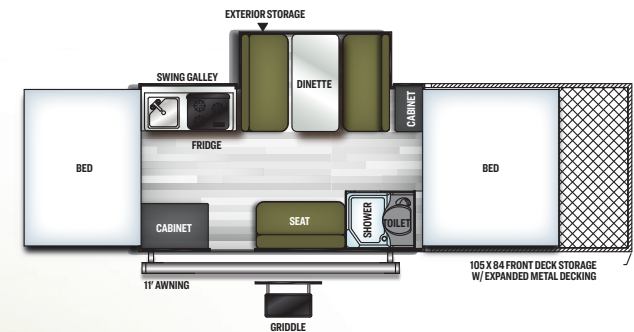

28TSCSE SE

FLAGSTAFF UVW: 3377 CCC: 1844 AXLE: 3118 HITCH: 221
 OPEN LENGTH: 30' 8" CLOSED HEIGHT: 6' 2" CLOSED LENGTH W/ HITCH: 26' 5"
 BOX SIZE: 12' FRESH: 20 GRAY: N/A BLACK: N/A



SE PACKAGE	SE STANDARD FEATURES			
Aluminum Wheels w/ 15" Mud Rover Tires	Gray Sport Exterior	TV Outlet w/Cable & Satellite Hook ups	E Z Lube Axles	Pro Rac Kayak Carrier
100W Roof Mount Solar Panel w/ 1000W Inverter	Slatewood Interior	35 amp Converter	Black Diamond Plate	Pro Rac Load Stops
Create-A-Breeze Roof Vent Fan	Wood Plank Flooring	30 Amp Detachable Power Cord	54" Front Deck Storage 23CSE	Pro Rac Tie Downs
3-Way Refrigerator	12 Volt Electric Water Pump	LED Ceiling Lights	96" Front Deck Storage 28TSCSE	40 Amp Portable Solar Panel
20K BTU Furnace	Hot Water Pkg. w/ Outside Shower (STD on 228BHSE/228SE/23CSE/28TSCSE)	Window Curtains w/ Valances	20 Gallon Fresh Water Tank	13,500 BTU Low Profile Roof Air
Heated Mattress Bunk Ends	Shower/Cassette Pack (std 228SE/23CSE/28TSCSE ONLY)	Double Step		15,000 BTU Low Profile Roof Air
Awning w/ LED Lighting	Double 20# Bottles (228SE/228BHSE/23CSE/28TSCSE)	100W Roof Mount Solar Panel w/ Prep For Addtl. Solar Panels	SE OPTIONS	
Spare Tire w/ Carrier & Cover	20# LP Bottle	Solar Prep On Frame	A/C Wiring Kit	
Outside Griddle	3-Burner Range w/Cover	Patio light	2-20# LP Bottles w/Cover (std 228BHSE/228SE/23CSE/28TSCSE)	
Power Roof Lift	Large Entry Door Grab Handle	Outside Recep	Overhead Kitchen Cabinet	
Bluetooth Stereo w/ Outside Speakers	Residential Style Cabinet Doors	Storage Net Over Bunk	Shower/Cassette Pack (228BHSE/228SE)	
Diamond Plate Accents	Full Extension Metal Drawer Guides	Vinolon Supreme Tent	Hot Water (Std 228BHSE/228SE/23CSE/28TSCSE)	
Spray Away Utility Hose	A/C Roof Bracing	Smoked Vinyl Windows	9' Screen Room w/Privacy Panels	
ProRac Permanent Crossbars (150lb Rating)	USB Charging Ports	Double Battery Box & Wiring	11' Screen Room w/Privacy Panels	
CO Detector		Sliding Storage Tray in trunk models	Pro Rac Upright Bike Carrier	
		Electric Brakes		
		4 Stabilizer Jack w/ Sand Pads		



HW27KS

High Wall

WE MAKE CAMPING COMFORTABLE. We have designed this series for the camping family who wants the refinement of larger vacationing units in a light-weight camper. Ample counterspace, upgraded appliances, convenient pull-up curtains providing a wide view of the surroundings and tasteful interiors make this camper a gorgeous option to experience.



Popular High Wall Features

- A** Shower curtain
- B** ProRac Roof Mounted Cross Bars w/ Opt. Bike and Kayak Carrier attachments.

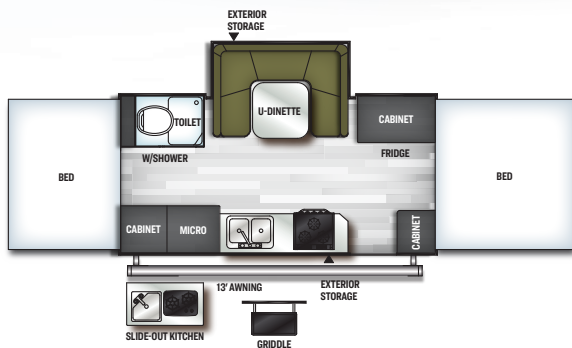

HW27KS HIGH WALL

FLAGSTAFF UVW: 3334 CCC: 546 AXLE: 2916 HITCH: 380
 OPEN LENGTH: 25' 9" CLOSED HEIGHT: 6' 7" CLOSED LENGTH W/ HITCH: 19' 6"
 BOX SIZE: 14' FRESH: 20 GRAY: 12 BLACK: 12

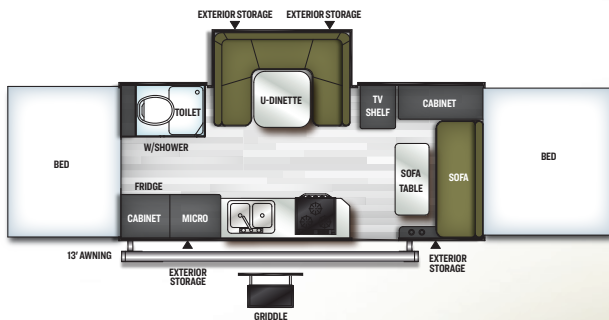

HW29SC HIGH WALL

FLAGSTAFF UVW: 3721 CCC: 1278 AXLE: 3312 HITCH: 371
 OPEN LENGTH: 27' 9" CLOSED HEIGHT: 6' 9" CLOSED LENGTH W/ HITCH: 21' 6"
 BOX SIZE: 16' FRESH: 20 GRAY: 12 BLACK: 12

HIGH WALL PACKAGE

- Create-A-Breeze Roof Vent Fan
- 3-Way Refrigerator
- 20K BTU Furnace
- Heated Mattress on Bunk Ends
- Awning w/ LED Lighting
- Power Roof Lift
- Spare Tire w/ Carrier & Cover
- Water Filtration System
- Aluminum Wheels
- Bloothooth Stereo w/ Outside Speakers
- ProRac Roof Mounting System
- CO Detector

HIGH WALL STANDARD FEATURES

- Slatewood Interior
- White Fiberglass w/ Gray Band Exterior
- Torsion EZ Lube Axles
- Raised Panel Cabinet Doors
- 4 Stabilizer Jacks with Sand Pads
- 1 Piece Floor
- 2 - Bed End Lights with Fan
- Wood Drawers with Full Extension Drawer Guides
- Positive Latches & Catches on Door & Drawers

14" Radial Tires

- 12 Volt Water Pump
- Double Battery Box & Wiring
- Large Entry Door Grab Handle
- 30 Amp Detachable Power Cord
- Solar Prep On Frame
- WiFi Extender w/ LTE capabilities
- Electric Brakes
- LED Ceiling Lights
- Outside Griddle
- 80" Beds
- Vinylon Supreme Tenting
- Privacy Curtains w/ Valances
- Hot Water pkg w/ Outside Shower
- Cable TV Ready

Oven

- Microwave
- Automatic Gas Regulator
- Double 20# Gas Bottles w/ Molded Cover
- Shower/Cassette Toilet
- 35 Amp Converter
- Monitor Panel
- Storage Nets On Both Bunks
- MORryde Step

HIGH WALL OPTIONS

- A/C Wiring Kit
- Overhead Kitchen Cabinet
- Hanging Wardrobe
- 13' Screen Room w/ Privacy Panels
- 13,500 BTU Roof A/C - Low Profile (a/c wiring kit included)
- 15,000 BTU A/C - Low Profile (a/c wiring kit included)
- Power Front Jack
- Pro Rac Upright Bike Carrier
- Pro Rac Kayak Carrier
- Pro Rac Load Stops
- Pro Rac Tie Downs
- 40 Amp Portable Solar Panel

Hard Sides

QUITE POSSIBLY THE BEST OF BOTH WORLDS. When you combine the solid exterior of a travel trailer with a tent camper, you get the Flagstaff Hard Side Series, giving your camping experience the best of both worlds. Bringing a smooth fiberglass vacuum bonded exterior with a quick, easy set up, while retaining the towing and storage advantages of a tent camper, the Hard Side camper is the perfect blend.

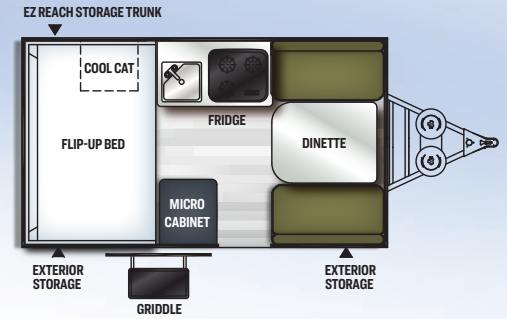

T12RB HARD SIDE

FLAGSTAFF UVW: 2014 CCC: 1208 AXLE: 1754 HITCH: 222
 CLOSED HEIGHT: 5' 1" CLOSED LENGTH W/ HITCH: 17' 5" BOX SIZE: 12'
 FRESH: 20 GRAY: N/A BLACK: N/A

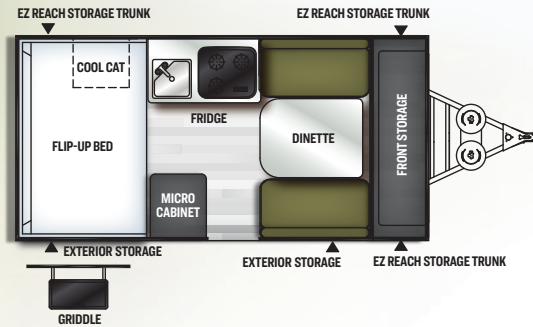

T12RBST HARD SIDE

FLAGSTAFF UVW: 2120 CCC: 1164 AXLE: 1798 HITCH: 284
 CLOSED HEIGHT: 5' 1" CLOSED LENGTH W/ HITCH: 19' 2" BOX SIZE: 12'
 FRESH: 20 GRAY: N/A BLACK: N/A

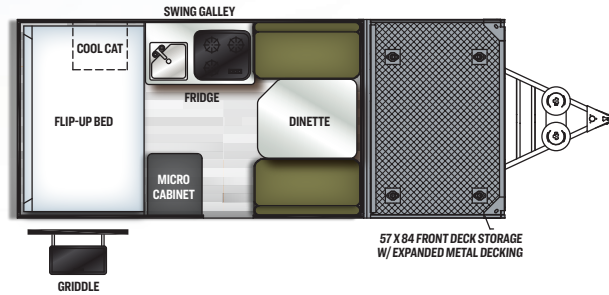

T12RBTH HARD SIDE

FLAGSTAFF UVW: 2408 CCC: 1387 AXLE: 2075 HITCH: 295
 CLOSED HEIGHT: 5' 8" CLOSED LENGTH W/ HITCH: 22' 3" BOX SIZE: 12'
 FRESH: 20 GRAY: N/A BLACK: N/A

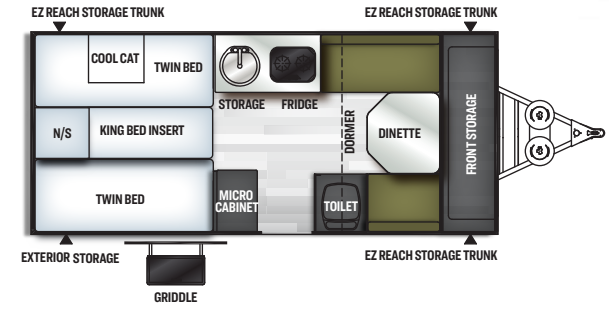

T21TBHW HARD SIDE

FLAGSTAFF UVW: 2670 CCC: 702 AXLE: 2260 HITCH: 372
 CLOSED HEIGHT: 5' 8" CLOSED LENGTH W/ HITCH: 21' 2" BOX SIZE: 14'
 FRESH: 20 GRAY: N/A BLACK: N/A

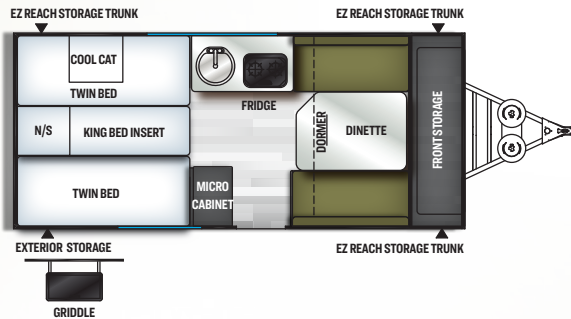

T21BHWOR HARD SIDE

FLAGSTAFF UVW: 2698 CCC: 1107 AXLE: 2355 HITCH: 305
 CLOSED HEIGHT: 6' 1" CLOSED LENGTH W/ HITCH: 21' 2" BOX SIZE: 14'
 FRESH: 20 GRAY: N/A BLACK: N/A

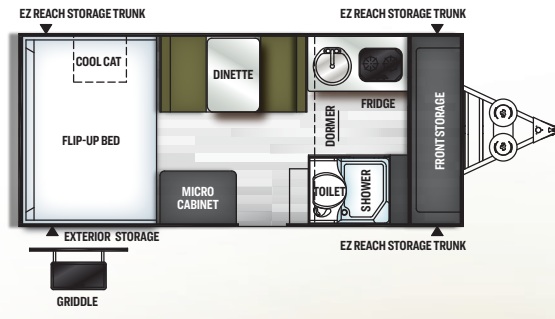

T21DMHW HARD SIDE

FLAGSTAFF UVW: 2700 CCC: 653 AXLE: 2309 HITCH: 353
 CLOSED HEIGHT: 5' 8" CLOSED LENGTH W/ HITCH: 21' 2" BOX SIZE: 14'
 FRESH: 20 GRAY: N/A BLACK: N/A

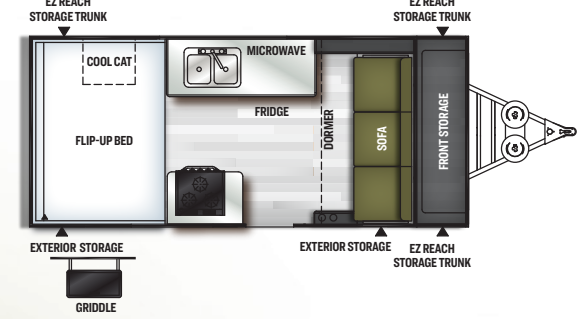

T21FSHW HARD SIDE

FLAGSTAFF UVW: 2648 CCC: 667 AXLE: 2295 HITCH: 315
 CLOSED HEIGHT: 5' 8" CLOSED LENGTH W/ HITCH: 21' 2" BOX SIZE: 14'
 FRESH: 20 GRAY: N/A BLACK: N/A



Hard Side High Wall Model Features

- A Power Roof Lift Assist**
(Hard Side High Wall only)
- B Gas Strut Lift Assist**
(Std. Hard Side Models w/
Manual Lift Roof Only)
- C Molded LP Bottle Covers**
(Std. Hard Side & Hard
Side High Wall)

HARD SIDE PACKAGE

10K BTU Cool Cat Heat Pump (A/C & Heater)
Create-A-Breeze Roof Vent Fan
3-Way Refrigerator
Heated Mattress on Master Bed (N/A T21TBHW & T21TBHWOR)
Aluminum Wheels w/ 15" Mud Rover Tires (T21TBHWOR & T12RBTH)
Spare Tire w/ Carrier & Cover
CO Detector
Water Filtration System
Stereo w/ Outside Speakers
WiFi Booster w/ LTE Prep
ProRac Permanent Crossbars (150lb rating)
Power Roof Lift (T21DMHW, T21FSHW, T21TBHW, T21TBHWOR)

HARD SIDE STANDARD FEATURES

White Fiberglass
Slatewood Interior
12 Volt Water Pump
Power Roof Lift (T21TBHWOR/ T21TBHW/ T21DMHW/ T21FSHW)
Torsion EZ Lube Axles
Hot Water Pkg w/ Outside Shower
Port-A-Potty (T12RBST/ T12RB)
Shower/Cassette Toilet (T21DMHW)
Residential Flush Toilet In Cabinet (T21DMHW only)
3 Burner Indoor Range w/ Cover
3 Burner Glass Top Stove w/ Oven (T21FSHW)
2 Burner Indoor Glass Top (T21TBHW/ T21TBHWOR/ T21DMHW)
Microwave

2.5 Cubic Foot 3 Way Refrigerator
Extra Large 3 Way Refrigerator (T21TBHWOR/ T21TBHW/ T21DMHW)
Solar Prep On Frame
Battery Box & Wiring
30 Amp Detachable Power Cord
35 Amp Converter
1/2 Sliding Storage Tray in Rear (Queen Bed Models Only)
LED Ceiling Lights
Raised Panel Cabinet Doors
Positive Latches & Catches On Doors & Drawers
Wood Drawers with Full Extension Metal Guides
Interior Floor Lights
Durable Diamond Plate Front
Fiberglass Laminated Roof

13" Radial Tires (T12RBST/ T12RB)
14" Radial Tires (T21 models)
Aluminum Wheels w/ 15" Mud Rover Tires with Aluminum Rims (T12RBTH/ T21TBHWOR)
Electric Brakes
4 Stabilizer Jacks w/ Sand Pads
Installed Door Step
Double Step (T21HW Models)
Large Folding Entry Door Grab Handle
Courtesy Light on Front
Outside Griddle
Cable TV Ready
Double 20# Gas Bottles w/ Molded Cover
Automatic Gas Regulator

HARD SIDE OPTIONS

Power Front Jack
12' Awning/Screen Room w/ Privacy Panels (T12 Models)
14' Awning/Screen Room w/ Privacy Panels
Hanging Wardrobe w/ 2 Shelves
Pro Rac Upright Bike Carrier
Pro Rac Kayak Carrier
Pro Rac Load Stops
Pro Rac Tie Downs
40 Amp Portable Solar Panel

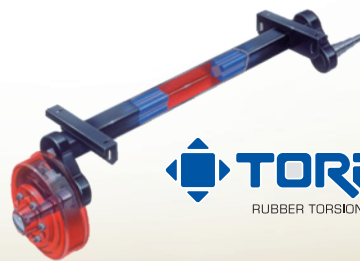

TORFLEX
RUBBER TORSION SUSPENSION AXLES

Dexter Torflex Axles

(STANDARD ON HIGH WALL AND HARD SIDE MODELS)

- Independent wheel suspension and self-damping action
- Rubber cushioning eliminates metal-to-metal contact.
- Forged torsion arm for maximum strength

Most models are also equipped with E-Z Lube® System and Nev-R-Adjust® Brakes.

Tent Camper Construction

THE FLAGSTAFF DIFFERENCE



- | | | |
|---|--|---|
| <p>A Three Stage Double Arm Lifter Posts (NA Hard Sides)</p> <p>B Fiberglass Vacuum Bonded Radius Roof w/ No Center Seam (NA Hard Sides)</p> <p>C Five-Piece Vinolon Supreme Tenting (NA Hard Sides)</p> <p>D E-Z Crank Down Stabilizer Jacks w/ Sand Pads</p> <p>E Full Perimeter Aluminum Bed Frames (NA Hard Sides)</p> | <p>F Plywood Bunk Ends (NA Hard Sides)</p> <p>G Seven-Way Pigtail Wiring</p> <p>H Under Floor 20 Gallon Fresh Water Tank (LTDs 10 Gallon Above Floor)</p> <p>I Powder Coated Tubular Steel Frame</p> <p>J Powder Coated Rafter Poles and Bed Bows (NA Hard Sides)</p> | <p>K Air Conditioner Reinforcing Laminated Into Roof (NA Hard Side)</p> <p>L Nitrogen Filled Steel Belted Radial Tires</p> <p>M Easy Lube Axle System (Except LTDs)</p> <p>N Smooth Fiberglass Vacuum Bonded Exterior (NA on MACs & SEs)</p> <p>O One-Piece Door (Except Hard Sides)</p> <p>P Under Awning LED Lighting (Except LTD's & Hard Sides)</p> |
|---|--|---|



1



3



2



4



5

1 Easy Glide Scissorpole Bed Supports (Except LTDs)

2 Heated Mattress (Std. Opt. NA T21DMHW)

3 EZ Reach Storage Trunk (Some Models)

4 Solar Panel Prep (Std. all models) The Zamp 40 amp. portable solar panel shown is sold separately.

5 WIFI Ranger Sky 4 WIFI Booster, with internet connectivity available. (NA on MAC, LTD's)



A



B

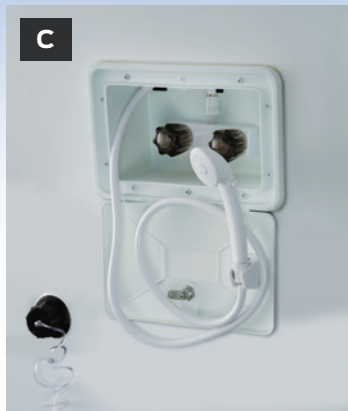

C



D



E



F



G



H

Tent Camper Popular Features

JUST A FEW FEATURES THAT PROVE OUR WORTH.

- A** Add-a-Room with Privacy Panels (Opt. all Models Except Hard Side)

- B** One-Piece Door (Except Hard Side) and Large Entry Assist Handle (Except LTDs)

- C** Outside Shower (Incl. w/ Hot Water Pkg: Std: Hard Side, High Wall and Opt: MAC)

- D** Outside Grill with Work Table (Std. MAC, SE, Hard Side, High Wall)

- E** Power Lift (Std. High Wall, SE, MAC. Opt. LTD)

- F** Under Awning LED Light (All Models Except LTDs and Hard Sides)

- G** ProRac Roof Mounted Cross Bars w/ Opt. Bike and Kayak Carrier attachments. (NA on LTDs)

- H** Black Water Hose Storage (Std. High Wall)

- I** Three Speed Ventilation Fan (Except LTDs)

- J** LED Bunk Light (Std. High Wall)

- K** Metal Full Extension Drawer Guides (Std.)

- L** AM/FM Stereo with Bluetooth and USB ports. (NA LTD & MAC)

- M** Swing Down Galley (Except LTDs, Hard Side, High Wall)

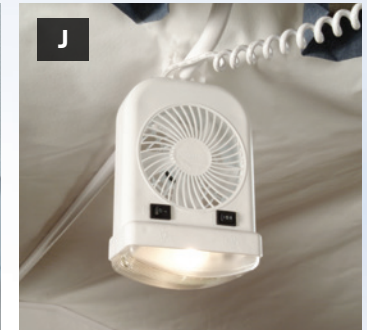



We work hard to make a quality product
so you can enjoy it for years to come.



Flagstaff Warranty. Our Promise.

FOR DETAILS ON FLAGSTAFF'S COMPLETE WARRANTY PROGRAM, SEE YOUR FLAGSTAFF DEALER.
When it comes to backing products with the same quality and commitment it does when it begins the manufacturing process, the only name you have to remember when you're looking for a recreational vehicle is Flagstaff. Flagstaff offers the following additional limited warranties to the original purchasers. Consult written warranty for details.

1. Five-year roof warranty (Excludes Hard Sides).
2. Twenty-five-year floor warranty.
3. Five-year frame warranty.
4. Five-year tent warranty.
5. Ten-year torsion axle warranty.
6. Limited lifetime warranty of lifter system (Excludes Hard Sides).



www.ForestRiverBuyLocal.com





**24/7 EMERGENCY
ROADSIDE ASSISTANCE
WITH VEHICLE PURCHASE***

<p>TOWING JUMP-STARTS TIRE CHANGES FLUID DELIVERY LOCKOUT SERVICE</p>	<p>WINCH-OUT MOBILE MECHANIC TECHNICAL SUPPORT DEALER LOCATOR SERVICES</p>
---	--



*VALID FOR 1 YEAR FROM DATE OF PURCHASE



PRE-DELIVERY INSPECTION FACILITY
20,000 square feet of quality assurance. The bare essentials for a premium product. This state-of-the-art facility gives immediate daily feedback to production for quality assurance in every unit built.

Specification Definitions :: GVWR (Gross Vehicle Weight Rating) - is the maximum permissible weight of the unit when fully loaded. It includes all weights, inclusive of all fluids, cargo, optional equipment and accessories. For safety and product performance do NOT exceed the GVWR. // **GAWR (Gross Axle Weight Rating)** - is the maximum permissible weight, including cargo, fluids, optional equipment and accessories that can be safely supported by a combination of all axles. // **UVW (Unloaded Vehicle Weight)** - is the typical weight of the unit as manufactured at the factory. It includes all weight at the unit's axle(s) and tongue or pin and LP Gas. The UVW does not include cargo, fresh potable water, additional optional equipment or dealer installed accessories. *Estimated average based on standard build optional equipment. // **CCC (Cargo Carrying Capacity)** - is the amount of weight available for fresh potable water, cargo, additional optional equipment and accessories. CCC is equal to GVWR minus UVW. Available CCC should accommodate fresh potable water (8.3 lbs per gallon). Before filling the fresh water tank, empty the black and gray tanks to provide for more cargo capacity. ** Estimated average based on standard build optional equipment. // Each Forest River RV is weighed at the manufacturing facility prior to shipping. A label identifying the unloaded vehicle weight of the actual unit and the cargo carrying capacity is applied to every Forest River RV prior to leaving our facilities. The load capacity of your unit is designated by weight, not by volume, so you cannot necessarily use all available space when loading your unit. // All information contained in this brochure is believed to be accurate at the time of publication. However, during the model year, it may be necessary to make revisions and Forest River, Inc., reserves the right to make all such changes without notice, including prices, colors, materials, equipment and specifications as well as the addition of new models and the discontinuance of models shown in this brochure. Therefore, please consult with your Forest River dealer and confirm the existence of any materials, design or specifications that are material to your purchase decision. Litho. U.S.A. FOR 1766 P&W: 2021.01.26

Look for our other popular lines of Flagstaff trailers.

YOUR **FLAGSTAFF** DEALER



FLAGSTAFF E-PROS



FLAGSTAFF FIFTH WHEELS



FLAGSTAFF TRAVEL TRAILERS



Learn More
Scan this barcode using a QR Reader on your smart phone to learn more about Forest River.



A Berkshire Hathaway company.

