

* ORIGINAL *

FLAGSTAFF

BY FOREST RIVER

TENT CAMPERS





DISCOVERY 147

Each Flagstaff Classic model comes with an abundance of cabinet storage, two large queen size beds, as well as a roomy dinette and sofa that both convert to beds.



You'll love the way the MAC/LTD's gas grill and accessory table conveniently mount to the exterior of the trailer.



The handy exterior shower (available with hot water package) makes sure that "messes" stay outside.



MAC/LTD SERIES

Whether your family desires to escape for the weekend or enjoy an extended vacation without the hustle and bustle of civilization, the popular MAC/LTD Series from Flagstaff is just what you've been looking for. With models ranging in size from 17'-22', the Flagstaff MAC series is sure to have a floorplan that fits both your family's needs and budget.



Flagstaff owners appreciate the time and effort that has gone into the engineering of each model, creating innovative living areas such as this slide-out model which increases the interior spaciousness by nearly 25%.



Flagstaff's beated, quilted innerspring mattresses provide sleeping comfort, especially on chilly nights.



The 3-speed Create-A-Breeze fantastic vent keeps air circulating for more comfortable camping.

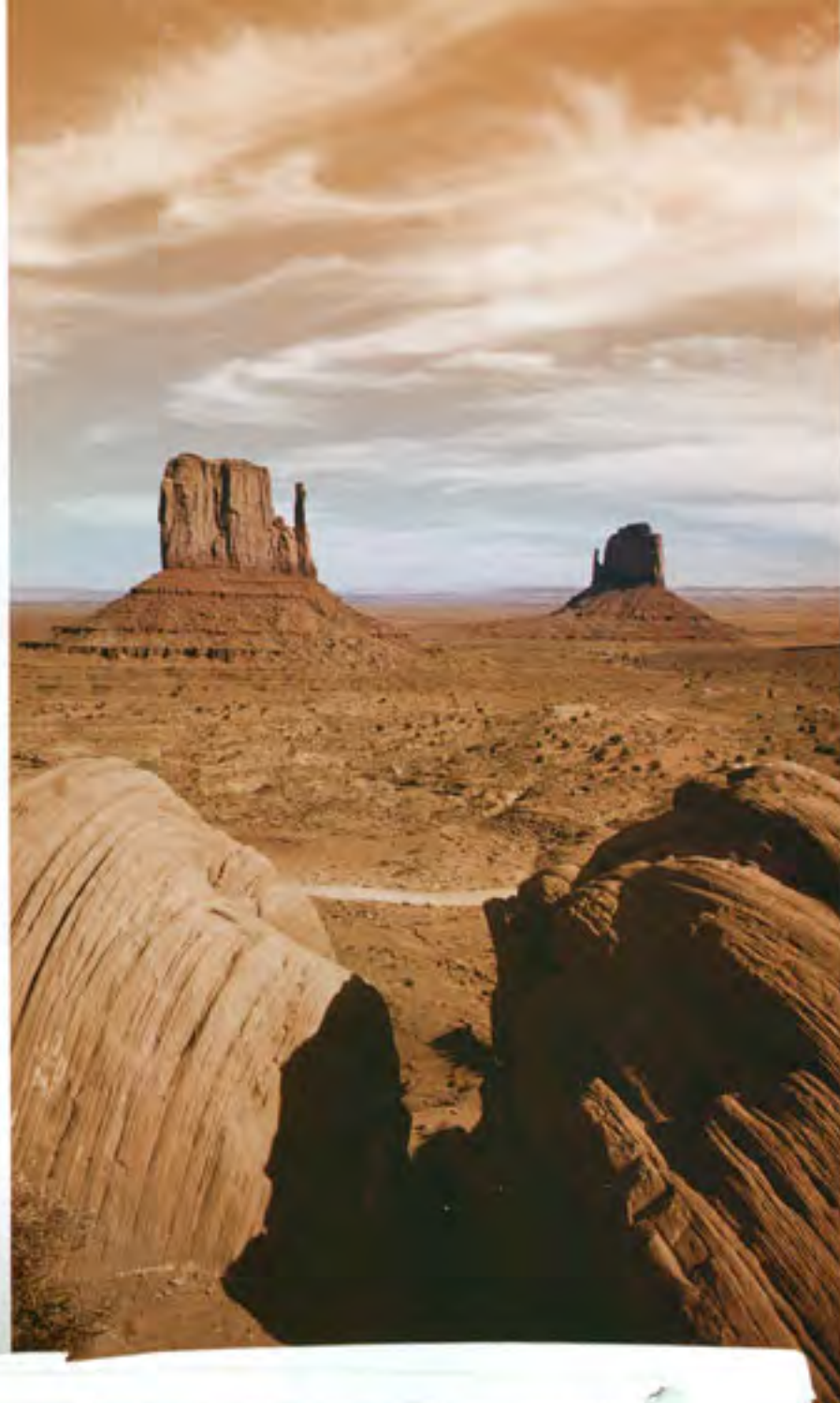

CLASSIC SERIES

Choose the Flagstaff Classic Series of tent campers from Forest River for the most affordable, best-built, camping trailers on the market. The Flagstaff Classic Series features eleven floorplans, ranging in size from 20' - 23', each designed to provide your family luxurious living conditions even in the most remote areas.



Steel air conditioner reinforcing is laminated into the roof.



Vinolon supreme sectionalized five piece tent.

Smooth filon exterior

Powder coated tubular steel frame

FLAGSTAFF CONSTRUCTION



A water pump is standard on all Flagstaff Tent Campers.



You'll appreciate the handy exterior electrical recepts.



The optional spare tire is conveniently mounted on the rear bumper.



The slide-out exterior storage tray means you can take all of your toys on your get-a-way.



Fiberglass vacuum-bonded radius roof with no center seam.

Powder coated rafter poles and bed bows.

Plywood bunk ends with full perimeter aluminum bed frames. (1,000 lbs. capacity)



Crank-down jacks with sand pads make stabilizing your unit fast and easy.



Our 3-stage double arm lifters are twice the size of many of our competitors.



The optional hanging pantry provides additional convenient storage space.



A full size screen door is standard on all Classic and MAC models.

* **STANDARDS** *

CLASSIC SERIES

AND OPTIONS

STANDARD FEATURES

- Residential Style Kitchen Faucet w/ Electric Water Pump
- Larger Deeper Sinks
- New Soft Quilted Top Innerspring Mattresses
- Outdoor Gas Grill w/ Worktable
- Sliding Storage Tray on all Front Trunk Models
- Water-Pur Filtration System w/ Shower Models & Hot Water Pkg.
- E-Z Crank-down Stabilizer Jacks w/ Sand Pads
- Electric Brakes (12' models)
- Residential Style Raised Panel Doors w/ Positive Latch Hardware
- 3 Double Ceiling Lights w/ Jacks for Accessories
- Bunk Light w/ Fan
- Large Lift Up Galley w/ Backsplash (most models)
- Slide-Out Range & Galley (725D Only)
- Permanently Mounted 3-Burner Indoor Range w/ Stove Cover
- Free Standing Table - High Pressure Laminate
- Comfortable Family Style Dinette w/ 4" Reversible Cushions
- Large Clothes Bar
- LP Leak Detector
- Drawer Guides

POPULAR EXTRAS

- Create-A-Breeze 3 Speed Fantastic Fan
- Create-A-Breeze 3 Speed Fantastic Fan
- Thermostatically Controlled Heated Mattresses
- 17,000 BTU Forced Air Furnace w/ Electric Ignition
- Extra-Large 2.5 Cubic Ft. Refrigerator
- A&E Free Standing Awning
- A&E Screen Room
- Convenience Pkg. (Incl. Lined Privacy Curtains, Roof Valances, Patio Light, 110 Exterior Outlet)
- Travel Pkg. (Incl. Spare Tire, Tire Bracket, Tire Cover, Step)
- Hot Water Pkg. - Incl. Water Filter, Outside Shower, 6 Gallon Hot Water Heater, Demand Water Pump (No outside shower 620, 720)

CONSTRUCTION FEATURES

- Smooth Fiberglass Vacuum Bonded Exterior
- 3-Stage Double Arm Lifter Posts
- Fiberglass Vacuum Bonded Radius Roof w/ No Center Seam
- Bay Window Models (524ST, 822, 823, & 425D)
- 1 Piece Screen Door on all Classic and MAC models - Except LTD.
- 5 Piece Sectionalized Vinolon Supreme Tenting
- Under Floor 20 Gallon Fresh Water Tank - Except LTD.
- Powder Coated Tubular Steel Frame
- One Piece Undercoated Structurewood Floor
- 13" Radial Tires (12' models)
- 7-Way Pigtail Plug
- Tent Permanently Attached on Bunk Ends and Slide Out
- Full Perimeter Aluminum Bed Frames
- Tinted Vinyl Windows
- Powder Coated Rafter Poles and Bed Bows
- Steel Air Conditioner Vent Reinforcing Laminated into Roof
- Plywood Bunk Ends
- Independent Torsion Axles
- Lower Door Operational in Closed Position
- 2000 lb. Tongue Jack w/ Swivel Wheel
- Seamless, High Density Polyethylene Wells

- Overhead Kitchen Pantry
- Hanging Wardrobe
- Power Lift System
- Bike Rack
- Boat Rack
- Battery Box and Wiring
- Air Conditioning Wiring Kit
- Electric Brakes (10' models)
- 15" Radial Tires (10' models)
- Dual 20 lb. LP Bottles

CLASSIC SERIES SPECIFICATIONS

Model	523	620	720	822	823	6250	524ST	425D	725D	823D	825D
GVWR (Gross Vehicle Weight Rating)	3036	2343	2355	3011	3006	3072	3077	3071	3095	3006	3070
Base/Dry Unit Weight	2297	1814	1730	2283	2225	2539	2258	2605	2581	2317	2447
Base/Dry Hitch Weight	316	243	255	291	286	352	357	351	375	281	350
Base/Dry Axle Weight	1981	1571	1475	1992	1939	2187	1901	2254	2206	2036	2097
Cargo Capacity	739	529	625	728	781	533	819	466	514	684	623
Box Size	12'	10'	10'	12'	12'	12'	12'	12'	12'	12'	12'
Trailer size (Closed - with hitch)	17'11"	15'5"	14'	17'11"	17'11"	17'11"	17'11"	17'11"	17'11"	15'5"	17'11"
Height (Closed)	61"	57"	57"	61"	61"	61"	61"	61"	61"	61"	61"
Trailer length (Open)	23'6"	20'2"	20'2"	23'6"	23'6"	23'6"	23'6"	23'6"	23'6"	23'6"	23'6"
Interior height	6'6"	6'6"	6'6"	6'6"	6'6"	6'6"	6'6"	6'6"	6'6"	6'6"	6'6"
Travel width	85"	85"	85"	85"	85"	85"	85"	85"	85"	85"	85"
Tire Size - 13"R std.	std.	12"R	12"R	std.	std.	std.	std.	std.	std.	std.	std.
Power converter with charger (amps)	25	25	25	25	25	25	25	25	25	25	25

Model number of any particular unit does not necessarily reflect the overall length of the unit itself. Dry weights are estimates.

* FLAGSTAFF *

CLASSIC SERIES

FLOORPLANS

620



720



523

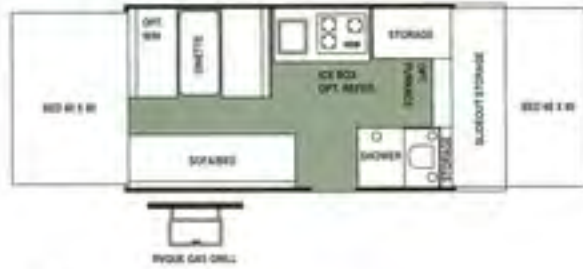

823



822

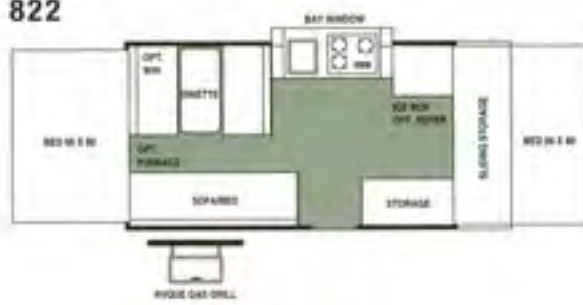

524ST



625D



823D

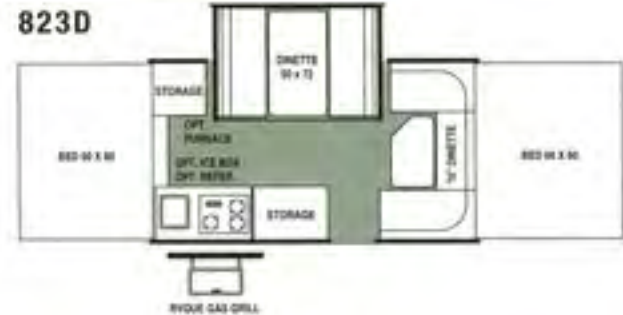

825D



425D



725D



* **STANDARDS** *

LTD/MAC SERIES

AND OPTIONS

MAC/LTD STANDARD FEATURES

- Residential Kitchen Faucet w/ Electric Water Pump
- Outside Gas Grill (Optional on LTD's)
- Water-Pur Filtration System w/ all Shower Models
- Permanently Mounted 3 Burner Indoor Range w/ Range Cover (except Ltd's)
- Converter w/ Built in Battery Charger
- Electric Brakes (12' models)
- Tinted Vinyl Windows
- Fold Over Galley with Upper and Lower Storage
- Exterior Work Table (except Ltd's)
- LP Leak Detector
- Automatic Safety Switch to Turn Off 12 Volt Current when Roof is Closed
- Large Built-In Icebox
- One Piece Screen Door (except Ltd's)
- Drawer guides

CONSTRUCTION FEATURES

- 3 Stage Double Arm Lifter Posts
- Fiberglass Vacuum Bonded Radius Roof w/ No Center Seam
- 5-Piece Vinolon Supreme Tenting
- E-Z Crank Down Stabilizer Jacks w/ Sand Pads
- Full Perimeter Aluminum Bed Frames
- Plywood Bunk Ends
- 7-Way Pigtail Wiring
- Under Floor 20 Gallon Fresh Water Tank (Ltd's 10 Gallon above floor)
- Powder Coated Tubular Steel Frame
- One Piece Undercoated Structurewood Floor
- Electric Brakes (12' Models)
- Powder Coated Rafter Poles and Bed Bows
- Steel Air Conditioner Reinforcing Laminated into Roof
- 13" Radial Tires on 12' Models (12" Radial Tires on 8' & 10' Models)
- Leaf-spring Axle
- Main Door Operational in Closed Position
- 2,000 lb. Tongue Jack w/ Swivel Wheel
- Seamless, High Density Polyethylene Wheel Wells

MAC POPULAR EXTRAS

- Create-A-Breeze 3 Speed Fantastic Fan
- Thermostatically Controlled Heated Bed Mattresses
- 17,000 BTU Forced Air Furnace w/ Electric Ignition
- Large 1.9 Cubic Ft. Refrigerator
- A&E Free Standing Awning
- Screen Room
- Convenience Pkg. (Incl. Lined Privacy Curtains, Roof Valances, Patio Light, 110 Exterior Outlet)
- Travel Pkg. (Incl. Spare Tire, Tire Bracket, Tire Cover, Step)
- Shower/Cassette Option (model 228 incl. Water Filtration System, 6 Gallon Hot Water Heater, Demand Water Pump, and Cassette Toilet)
- Overhead Kitchen Pantry
- Power Lift System
- Bike Rack
- Boat Rack
- Battery Box and Wiring
- Air Conditioner Wiring Kit
- Electric Brakes (standard on 12' models)
- Dual 20 Lb. LP Bottles

LTD STANDARD FEATURES

- Spare Tire
- Awning
- Roof Vent
- Privacy Curtains
- Rear Crank Down Stabilizer Jacks w/ Sand Pads
- Outside Recep. (206 LTD only)
- Patio Light (206 LTD only)
- Step

LTD POPULAR EXTRAS

- Thermostatically Controlled Heated Bed Mattresses
- Large 1.9 Cubic Ft. Refrigerator
- 17,000 BTU Forced Air Furnace w/ Electronic Ignition
- Screen Room
- Electric Brakes
- Outside Gas Grill

FLAGSTAFF LTD/MAC SPECIFICATIONS

Model	176ST	176ED	206ST	205	208	227	228	21FB	228D	176LTD	206LTD
GVWR (Gross Vehicle Weight Rating)	2287	2259	2341	2355	2319	2984	2975	3111	3015	2278	2339
Base/Dry Unit Weight	1574	1336	1719	1635	1569	1809	1845	2019	2079	1353	1486
Base/Dry Hitch Weight	187	159	241	255	219	269	255	391	295	178	239
Base/Dry Axle Weight	1387	1177	1478	1380	1350	1540	1590	1628	1784	1175	1247
Cargo Capacity	713	923	622	745	750	560	510	1092	936	925	853
Box Size	8'	8'	10'	10'	10'	12'	12'	12'	12'	8'	10'
Trailer size (Closed - with hitch)	14'	12'	15'11"	14'	14'	15'11"	15'11"	16'6"	15'11"	12'	14'
Height (Closed)	57"	57"	57"	57"	57"	57"	57"	57"	57"	57"	57"
Trailer length (Open)	17'	17'	20'2"	20'2"	20'2"	22'6"	22'6"	22'6"	22'6"	17'	20'2"
Interior height	6'6"	6'6"	6'6"	6'6"	6'6"	6'6"	6'6"	6'6"	6'6"	6'6"	6'6"
Travel width	85"	85"	85"	85"	85"	85"	85"	85"	85"	85"	85"
Tire Size - 12"R std.	std.	std.	std.	std.	std.	13"R	13"R	13"R	13"R	std.	std.
Power converter with charger (amps)	12	12	12	25	12	12	12	12	25	12	12

Model number of any particular unit does not necessarily reflect the overall length of the unit itself. Dry weight are estimates.

* **FLAGSTAFF** *

LTD/MAC SERIES

FLOORPLANS

176ST



176ED



206ST



205

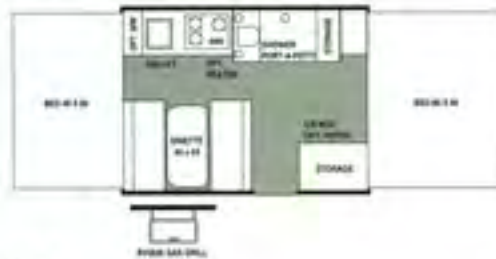

208



227



228



229



228D



176LTD



206LTD





YOUR FLAGSTAFF DEALER

ROBERTS SALES
741 S. Federal Blvd.
Denver, Colo. 80219
303-922-6221
www.robertssales.com



DISCOVERY 147 

For details on Flagstaff's complete warranty program, see your Flagstaff dealer. When it comes to backing products with the same quality and commitment it does when it begins the manufacturing process, the only name you have to remember when you're looking for a recreational vehicle is Flagstaff. Flagstaff offers the following additional limited warranties to the original purchasers. Consult written warranty for details.

- 1. Limited Lifetime lifter system warranty, 2. Five-year roof warranty,
- 3. Twenty-five-year floor warranty, 4. Five-year frame warranty,
- 5. Five-year tent warranty

Contact your Flagstaff dealer about the Lifetime warranty available to you.



Forest River, Inc., 201 West Elm St., Millersburg, IN, 46543
574.642.2640 www.forestriverinc.com www.forestriveraccessories.com

All specifications contained herein are based on the latest product information at time of printing. Forest River reserves the right to make changes in colors, materials, equipment and specifications at anytime without notice and assumes no responsibility for any errors in this brochure.

* ORIGINAL *
FLAGSTAFF
BY FOREST RIVER
**HIGH-WALL
TENT CAMPERS**



* STANDARDS *

HIGH-WALL

AND OPTIONS

STANDARD FEATURES

- Double pan sink / with high goose neck faucet
- 14" tires with aluminum rims
- 3500 LBS torsion axles by AL-KO
- New exterior graphics
- New white interior with "wood look" linoleum
- AM/FM cassette stereo with CD player
- TV outlet with cable and satellite hook up
- Three burner stove with oven
- Microwave
- Hot water package (incl. water filter, outside shower, DSI 6 gallon hot water heater, demand water pump)
- Outside shower
- Electric water pump
- Water purifier
- 2- 20 lb. gas bottles
- Diamond plated metal cap
- Battery box storage
- Stainless steel appliances and sink
- 6 gallon gray water holding tank
- Laminated floor
- Bunk light with fan
- One-piece screen door
- Electric brakes
- Dual 20 lb. LP bottles

OPTIONS

- 13,500 BTU air conditioner
- Create-a-Breeze 3 speed Fantastic fan
- Thermostatically controlled heated mattresses
- 17,000 BTU forced air furnace w/electric ignition
- A&E screen room
- A&E free standing awning
- Convenience package (incl. lined privacy curtain, roof valances, patio light, 110 exterior outlet)
- Travel package (incl. spare tire, tire bracket, tire cover, step)
- Power lift system
- Battery box and wiring



625D



825D



Model	625D	825D
G.V.W.R. (Gross Vehicle Weight Rating)	3,917	3,947
Base/Dry Unit Weight	2,853	2,803
Base/Dry Hitch Weight	417	447
Base/Dry Axle Weight	2,436	2,356
Cargo Capacity	860	940
Box Size	12'	12'
Trailer size (Closed - with hitch)	18'6"	18'6"
Height (Closed)	68"	68"
Trailer length (Open)	22'6"	22'6"
Interior height	88"	88"
Travel width	85"	85"

Model number of any particular unit does not necessarily reflect the overall length of the unit itself. Dry weight are estimates.

For details on Flagstaff's complete warranty program, see your Flagstaff dealer. When it comes to backing products with the same quality and commitment it does when it begins the manufacturing process, the only name you have to remember when you're looking for a recreational vehicle is Flagstaff. Flagstaff offers the following additional limited warranties to the original purchasers. Consult written warranty for details. 1. Limited Lifetime lifter system warranty, 2. Five-year roof warranty, 3. Five-year frame warranty, 4. Five-year roof warranty. **Contact your Flagstaff dealer about the Lifetime warranty available to you.**



Forest River, Inc.
P.O. Box 3030 55470 County Road 1
Elkhart, IN 46515-3030
574.642.2640
www.forestriverinc.com
www.forestriveraccessories.com

ROBERTS SALES

741 S. Federal Blvd.
Denver, Colo. 80219
303-922-6221

www.robertssales.com



All specifications contained herein are based on the latest product information at time of printing. Forest River reserves the right to make changes in color, materials, equipment and specifications at anytime without notice and assumes no responsibility for any errors in this brochure.