

*Forest River presents*  
**FLAGSTAFF**

||| TENT CAMPERS |||



# CLASSIC *series*



**GO AHEAD. STRETCH OUT.** *There's plenty of room to relax.*

For years, Flagstaff has been producing the best-built, most innovatively designed camping trailers on the market. The Classic series from Flagstaff is a true representation of this and offers tent camper living at its finest. This high end tent camper will offer you all the amenities your family needs to make their camping experiences and memories last a life time. Careful thought and care is taken into consideration in creating the Classic series. Your camping experience is enhanced by these features shown on the right.





**RVQ GRILL (STD. EXCEPT LTD.)**



**SLIDING STORAGE TRUNK  
(SOME MODELS)**



**PORT-A-POTTY  
(SOME MODELS)**



**HANGING SHIRT BAR  
(STD. ON CLASSICS)**



**HANGING PANTRY (OPT.)**



**3-SPEED FAN WITH LIGHT  
(STD. WITH CLASSIC)**



**SHOWER (SOME MODELS)**



**OUTSIDE SHOWER (ON SHOWER  
MODELS OPTIONAL WITH HOT  
WATER PACKAGE)**



**BIKE RACK (OPT.)**



**HANGING WARDROBE**

# LTD/MAC *series*



## WE'RE THE BEST FOR GOOD REASON: *Our standard features.*

The MAC tent camper by Flagstaff is value packed. Our list of standard features is one that you and your family will truly enjoy. We invite you to take a look and see why the Flagstaff MAC is the right camper for you and your family.



# LTD/MAC *series*

A weekend away shouldn't be a weekend without comfort. Enjoy your favorite grilled meals. Take all the toys for the kids. There's plenty of room to keep it all.



PLYWOOD BED END SUPPORT



HEATED MATTRESS PADS (STD.OPT.)



EXTERIOR ELECTRICAL PLUGS  
(EXCEPT 176 LTD)



ONE-PIECE DOOR  
(EXCEPT LTD.)



SPARE TIRE (OPT.)



DOUBLE 3-STAGE LIFTER POST



WATER PUMP (STD.)



3-SPEED FAN (STD. OPT.)



CRANK DOWN STABILIZER  
JACKS WITH SANDPADS (STD.)

# FLAGSTAFF *construction*

Steel air conditioner reinforcing is laminated into the roof.

Vinolon supreme sectionalized five piece tent.

Powder coated tubular steel frame

Smooth fiberglass finish (Classic only)

Easy lube axles (Except LTD)

In-frame 20 gal. fresh water tank (Except LTD)





Fiberglass vacuum bonded radius roof with no center seam.

Powder coated rafter poles and bed bows.

Plywood bunk ends with full perimeter aluminum bed frames. (1,000 lbs. capacity)

Heated innerspring mattress (Classic only)

Sliding storage (On trunk models)

Stabilizer jacks with sand pads

**THE FLAGSTAFF TENT CAMPERS HAVE A STRONG FOUNDATION. THIS IS DUE TO THE QUALITY CONSTRUCTION AND FEATURES SEEN HERE.**

# CLASSIC *standards & options*

## CLASSIC STANDARD FEATURES

- Residential Style Kitchen Faucet w/ Electric Water Pump
- Larger Deeper Sinks
- Create-A Breeze 3 Speed Fantastic Fan (STD. OPT.)
- Thermostatically Controlled Heated Mattresses (STD. OPT.)
- Soft Quilted Top Innerspring Mattresses
- Outdoor Gas Grill w/ Worktable
- Sliding Storage Tray on all Front Trunk Models
- Water-Pur Filtration System w/ Shower Models & Hot Water Pkg.
- E-Z Crank-down Stabilizer Jacks w/ Sand Pads
- Electric Brakes (12' models)
- Residential Style Raised Panel Doors
- 3 Double Ceiling Lights w/ Jacks for Accessories
- Bunk Light w/ Fan
- Large Lift Up Galley w/ Backsplash (most models)
- Permanently Mounted 3-Burner Indoor Range w/ Stove Cover
- Free Standing Table - High Pressure Laminate
- Comfortable Family Style Dinette w/ 4" Reversible Cushions
- Large Clothes Bar
- LP Leak Detector
- Metal drawer guides
- Port-a-Potty in 425D and 620 Models

## CLASSIC CONSTRUCTION FEATURES

- Smooth Fiberglass Vacuum Bonded Exterior
- 3-Stage Double Arm Lifter Posts
- Fiberglass Vacuum Bonded Radius Roof w/ No Center Seam
- Bay Window Models (524ST, 822, 823, & 425D)
- 1 Piece Screen Door
- 5 Piece Sectionalized Tenting
- Under Floor 20 Gallon Fresh Water Tank
- Powder Coated Tubular Steel Frame
- One Piece Undercoated Structurewood Floor
- 13" Radial Tires (12' models)
- 7-Way Pigtail Plug
- Tent Permanently Attached on Bunk Ends and Slide Out
- Full Perimeter Aluminum Bed Frames
- Tinted Vinyl Windows
- Powder Coated Rafter Poles and Bed Bows
- Steel Air Conditioner Reinforcing Laminated into Roof
- Two Tone Fabric Interior
- Plywood Bunk Ends
- Independent Easy Lube Torsion Axles
- Lower Door Operational in Closed Position
- 2000 lb. Tongue Jack w/ Swivel Wheel
- Seamless, High Density Polyethylene Wells
- Battery Box and Wiring Kit (Except LTD)
- Breathable Bed End Canvas

## CLASSIC POPULAR EXTRAS

- 17,000 BTU Forced Air Furnace w/ Electric ignition
- Extra-Large 2.5 Cubic Ft. Refrigerator
- Free Standing Awning
- Screen Room
- Convenience Pkg. (Incl. Lined Privacy Curtains, Roof Valances, Patio Light, 110 Exterior Outlet)
- Travel Pkg. (Incl. Spare Tire, Tire Bracket, Tire Cover, Step)
- Hot Water Pkg. - Incl. Water Filter, Outside Shower, 6 Gallon Hot Water Heater, Demand Water Pump (No outside shower 620, 720)

- Overhead Kitchen Pantry
- Hanging Wardrobe
- Power Lift System
- Bike Rack
- Air Conditioning Wiring Kit
- Electric Brakes (10' models)
- 13" Radial Tires (10' models)
- Dual 20 lb. LP Bottles

## FLAGSTAFF CLASSIC SERIES

MODEL	620ST	720	524SS	523	822	823	625D	425D	823D	825D
GVWR (Gross Vehicle Weight Rating)	2343	2355	3127	3036	3011	3006	3070	3071	3006	3070
Base/Dry Unit Weight	1814	1730	2605	2297	2283	2225	2447	2605	2317	2447
Base/Dry Hitch Weight	243	255	407	316	291	286	350	351	281	350
Base/Dry Axle Weight	1571	1475	2198	1981	1992	1939	2097	2254	2038	2097
Cargo Capacity	341	437	334	551	540	593	435	278	496	435
Box Size	10'	10'	12'	12'	12'	12'	12'	12'	12'	12'
Trailer size (Closed - with hitch)	15'5"	14'	17'11"	17'11"	17'11"	17'11"	17'11"	17'11"	15'5"	17'11"
Height (Closed)	57"	57"	61"	61"	61"	61"	61"	61"	61"	61"
Trailer length (Open)	20'2"	20'2"	23'6"	23'6"	23'6"	23'6"	23'6"	23'6"	23'6"	23'6"
Interior height	6'6"	6'6"	6'6"	6'6"	6'6"	6'6"	6'6"	6'6"	6'6"	6'6"
Travel width	85"	85"	85"	85"	85"	85"	85"	85"	85"	85"
Tire Size - 13"R std.	12"	12"	12"	std.	std.	std.	std.	std.	std.	std.
Power converter with charger: amps	25	25	25	25	25	25	25	25	25	25

Model number of any particular unit does not necessarily reflect the overall length of the unit itself. Dry weight are estimates.



# CLASSIC *floorplans*

620ST



720



823



523



524SS



822



823D



625D



425D



825D



# LTD/MAC *standards & options*

## LTD/MAC STANDARD FEATURES

- Residential Kitchen Faucet w/ Electric Water Pump
- Create-A Breeze 3 Speed Fantastic Fan (STD. OPT.)
- Thermostatically Controlled Heated Mattresses (STD. OPT.)
- Soft Quilted-Top Bed Mattresses (4" High Density Foam)
- Outside Gas Grill (Optional on LTD's)
- Water-Pur Filtration System w/ all Shower Models
- Permanently Mounted 3 Burner Indoor Range w/ Range Cover (Except LTD's)
- Converter w/ Built in Battery Charger
- Electric Brakes (12' models)
- Tinted Vinyl Windows
- Fold Over Galley with Upper and Lower Storage
- Exterior Work Table (Except Ltd's)
- LP Leak Detector
- Automatic Safety Switch to Turn Off 12 Volt Current when Roof is Closed
- Large Built-In Icebox
- One Piece Screen Door (Except Ltd's)
- Drawer guides
- Port-a-Potty 206ST and 229 models

## MAC POPULAR EXTRAS

- 17,000 BTU Forced Air Furnace w/ Electric Ignition
- Large 1.9 Cubic Ft. Refrigerator
- Free Standing Awning
- Screen Room
- Convenience Pkg. (Incl. Lined Privacy Curtains, Roof Valances, Patio Light, 110 Exterior Outlet)
- Travel Pkg. (Incl. Spare Tire, Tire Bracket, Tire Cover, Step)
- Shower/Cassette Option (Model 228D incl. Water Filtration System, 6 Gallon Hot Water Heater, Demand Water Pump, and Cassette Toilet)
- Overhead Kitchen Pantry
- Power Lift System
- Bike Rack
- Air Conditioner Wiring Kit
- Electric Brakes (Standard on 12' models)
- Dual 20 Lb. LP Bottles

## LTD/MAC CONSTRUCTION FEATURES

- 3 Stage Double Arm Lifter Posts
- Fiberglass Vacuum Bonded Radius Roof w/ No Center Seam
- 5-Piece Tenting
- E-Z Crank Down Stabilizer Jacks w/ Sand Pads
- Full Perimeter Aluminum Bed Frames
- Plywood Bunk Ends
- 7-Way Pigtail Wiring
- Under Floor 20 Gallon Fresh Water Tank (LTD's 10 Gallon above floor)
- Powder Coated Tubular Steel Frame
- One Piece Undercoated Structurewood Floor
- Electric Brakes (12' Models)
- Powder Coated Rafter Poles and Bed Bows
- Steel Air Conditioner Reinforcing Laminated into Roof
- 13" Radial Tires on 12' Models (12" Radial Tires on 8' & 10' Models)
- Leaf-spring Axle
- Main Door Operational in Closed Position
- 2,000 lb. Tongue Jack w/ Swivel Wheel
- Easy lube axles
- Seamless, High Density Polyethylene Wheel Wells
- Battery Box and wiring kit (Except LTDS.)
- Breathable Bunk End Canvas

## LTD STANDRAD FEATURES

- Spare Tire
- Awning
- Roof Vent
- Privacy Curtains
- Thermostatically Controlled Heated Bed Mattresses (STD. OPT.)
- Rear Crank Down Stabilizer Jacks w/ Sand Pads
- Outside Recep. (206 LTD only)
- Patio Light (206 LTD only)
- Step

## LTD POPULAR EXTRAS

- Large 1.9 Cubic Ft. Refrigerator
- 17,000 BTU Forced Air Furnace w/ Electronic Ignition
- Screen Room
- Electric Brakes
- Outside Gas Grill

## FLAGSTAFF LTD/MAC SERIES

MODEL	176ST	176ED	206ST	205	208	226D	227	228	229	228D	176LTD	206LTD
GVWR (Gross Vehicle Weight Rating)	2287	2259	2341	2355	2319	3046	2989	2975	3111	3015	2278	2339
Base/Dry Unit Weight	1574	1336	1719	1635	1569	1620	1809	1845	2019	2079	1353	1486
Base/Dry Hitch Weight	187	159	241	255	219	326	269	255	391	295	178	239
Base/Dry Axle Weight	1387	1177	1478	1380	1350	1294	1540	1590	1628	1784	1175	1247
Cargo Capacity	525	735	434	532	562	1238	992	942	944	784	810	738
Box Size	8'	8'	10'	10'	10'	12'	12'	12'	12'	12'	8'	10'
Trailer size (Closed - with hitch)	14'	12'	15'11"	14'	14'	16'6"	15'4"	15'11"	16'6"	15'11"	12'	14'
Height (Closed)	57"	57"	57"	57"	57"	57"	57"	57"	57"	57"	57"	57"
Trailer length (Open)	17'	17'	20'2"	20'2"	20'2"	22'6"	22'6"	22'6"	22'6"	22'6"	17'	20'2"
Interior height:	6'6"	6'6"	6'6"	6'6"	6'6"	6'6"	6'6"	6'6"	6'6"	6'6"	6'6"	6'6"
Travel width	85"	85"	85"	85"	85"	85"	85"	85"	85"	85"	85"	85"
Tire Size - 13"R std.	12"R	12"R	12"R	12"R	12"R	std.	std.	std.	std.	std.	12"R	12"R
Power converter with charger: amps	12	12	12	12	12	12	12	12	12	12	12	12

Model number of any particular unit does not necessarily reflect the overall length of the unit itself. Dry weight are estimates.

# LTD/MAC *floorplans*

176ST



176ED



206ST



205



208



226D



227



228



229



228D



176 LTD



206 LTD

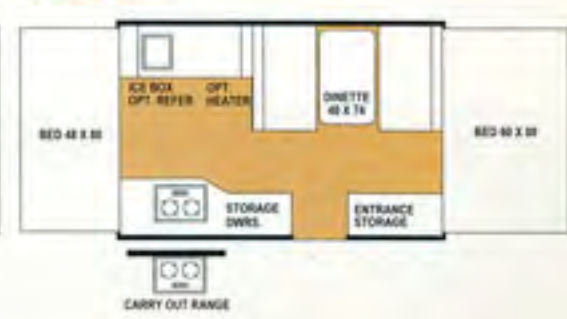



YOUR FLAGSTAFF DEALER

**ROBERTS SALES**  
741 S. Federal Blvd.  
Denver, Colo. 80219  
303-922-6221



For details on Flagstaff's complete warranty program, see your Flagstaff dealer. When it comes to backing products with the same quality and commitment it does when it begins the manufacturing process, the only name you have to remember when you're looking for a recreational vehicle is Flagstaff.

Flagstaff offers the following additional limited warranties to the original purchasers. Consult written warranty for details.

1. Five-year roof warranty,
2. Twenty-five-year floor warranty,
3. Five-year frame warranty,
4. Five-year tent warranty,
5. Five-year warranty on torsion axle suspension,
6. Limited life-time warranty of lifter system,
7. One-year bumper to bumper

Ask your dealer about the available lifetime structural warranty.

All specifications contained herein are based on the latest product information at time of printing. Forest River reserves the right to make changes in colors, materials, equipment and specifications at any time without notice and assumes no responsibility for any errors in this brochure.



Forest River, Inc. 55470 C.R. 1 Elkhart, IN 46515

574-389-4600 [www.forestriverinc.com](http://www.forestriverinc.com) [www.forestriveraccessories.com](http://www.forestriveraccessories.com)

*Forest River presents*  
**FLAGSTAFF**  
❧ HIGH SIDEWALL TENT CAMPERS ❧



# HIGH WALL CAMPERS

*standards & options*

## STANDARD FEATURES

- Double pan sink / with high goose neck faucet
- 14" tires with aluminum rims
- 3500 LBS torsion axles by AL-KO
- New exterior graphics
- New white interior with "wood look" linoleum
- AM/FM cassette stereo with CD player
- TV outlet with cable and satellite hook up
- Three burner stove with oven
- Microwave
- Hot water package (incl. water filter, outside shower, DSI 6 gallon hot water heater, demand water pump)
- Outside shower
- Electric water pump
- Water purifier
- 2- 20 lb. gas bottles
- Diamond plated metal cap
- Battery box storage
- Stainless steel appliances and sink
- 6 gallon gray water holding tank
- Laminated floor
- Bunk light with fan
- One-piece screen door
- Electric brakes
- Battery box and wiring kit
- Easy-lube axles



HW256G



RIVOLE GAS GRILL  
OUTSIDE RANGE

HW258G



RIVOLE GAS GRILL  
OUTSIDE RANGE

## OPTIONS

- 13,500 BTU air conditioner
- Create-a-Breeze 3 speed Fantastic fan
- Heated innerspring mattresses
- 17,000 BTU forced air furnace w/ electric ignition
- Screen room
- Awning
- Convenience package (incl. lined privacy curtain, roof valances, patio light, 110 exterior outlet)
- Travel package (incl. spare tire, tire bracket, tire cover, step)

MODEL	HW256G	HW258G
GVR (Gross Vehicle Weight Rating)	3,947	3,917
Base/Dry Unit Weight	2,803	2,853
Base/Dry Hitch Weight	447	417
Base/Dry Axle Weight	2,356	2,436
Cargo Capacity	940	860
Box Size	12'	12'
Trailer size (Closed - with hitch)	18'6"	18'6"
Height (Closed)	68"	68"
Trailer length (Open)	22'6"	22'6"
Interior height	88"	88"
Travel width	85"	85"

Model number of any particular unit does not necessarily reflect the overall length of the unit itself. Dry weight are estimates.

For details on Flagstaff's complete warranty program, see your Flagstaff dealer.

When it comes to backing products with the same quality and commitment it does when it begins the manufacturing process, the only name you have to remember when you're looking for a recreational vehicle is Flagstaff.

Flagstaff offers the following additional limited warranties to the original purchasers. Consult written warranty for details. 1. Limited Lifetime lifter system warranty, 2. Five-year roof warranty, 3. Twenty-five-year floor warranty, 4. Five-year frame warranty, 5. Five-year tent warranty, 6. One-year bumper to bumper warranty. Contact your dealer about the available lifetime structural warranty.

All specifications contained herein are based on the latest product information at time of printing. Forest River reserves the right to make changes in colors, materials, equipment and specifications at any time without notice and assumes no responsibility for any errors in this brochure.



Forest River, Inc.  
55470 C.R.I., Elkhart, IN, 46515-3030  
574.389.4600  
www.forestriverinc.com  
www.forestriveraccessories.com

YOUR FLAGSTAFF DEALER